



- U.S.A. : **KUBOTA TRACTOR CORPORATION**  
3401 Del Amo Blvd., Torrance, CA 90503, U.S.A.  
Telephone : (310)370-3370
- Western Division : 1175 S. Guild Av., Lodi, CA 95240  
Telephone : (209)334-9910
- Central Division : 14855 FAA Blvd., Fort Worth, TX 76155  
Telephone : (817)571-0900
- Northern Division : 6300 at One Kubota Way, Groveport, OH 43125  
Telephone : (614)835-1100
- Southeast Division : 1025 Northbrook Parkway, Suwanee, GA 30024  
Telephone : (770)995-8855
- Canada : **KUBOTA CANADA LTD.**  
5900 14th Avenue, Markham, Ontario, L3S 4K4, Canada  
Telephone : (905)294-7477
- France : **KUBOTA EUROPE S.A.S**  
19-25, Rue Jules Vercey, Z.I. BP88, 95101 Argenteuil Cedex, France  
Telephone : (33)1-3426-3434
- Italy : **KUBOTA EUROPE S.A.S Italy Branch**  
Via Grandi, 29 20068 Peschiera Borrome (MI) Italy  
Telephone : (39)02-51650377
- Germany : **KUBOTA (DEUTSCHLAND) GmbH**  
Senefelder Str. 3-5 63110 Rodgau /Nieder-Roden, Germany  
Telephone : (49)6106-873-0
- U.K. : **KUBOTA (U.K.) LTD.**  
Dormer Road, Thame, Oxfordshire, OX9 3UN, U.K.  
Telephone : (44)1844-214500
- Spain : **KUBOTA ESPAÑA S.A.**  
Avenida Recomba No.5, Poligono Industrial la Laguna, Leganes, 28914 (Madrid) Spain  
Telephone : (34)91-508-6442
- Australia : **KUBOTA TRACTOR AUSTRALIA PTY LTD.**  
25-29 Permas Way, Truganina, VIC 3029, Australia  
Telephone : (61)-3-9394-4400
- Malaysia : **SIME KUBOTA SDN. BHD.**  
No.3 Jalan Sepadu 25/123 Taman Perindustrian Axis,  
Seksyen 25, 40400 Shah Alam, Selangor Darul Ehsan Malaysia  
Telephone : (60)3-736-1388
- Philippines : **KUBOTA PHILIPPINES, INC.**  
155 Panay Avenue, South Triangle Homes, 1103 Quezon City, Philippines  
Telephone : (63)2-9201071
- Taiwan : **SHIN TAIWAN AGRICULTURAL MACHINERY CO., LTD.**  
16, Fengping 2nd Rd, Taliaw Shiang Kaohsiung 83107, Taiwan R.O.C.  
Telephone : (886)7-702-2333
- Indonesia : **PT. KUBOTA MACHINERY INDONESIA**  
Tower A at EightyEight@Kasablanka Lantai 16  
Jalan Raya Casablanka Kav. 88, Jakarta 12870 Indonesia  
Telephone : (62)-21-29568-720
- Thailand : **SIAM KUBOTA CORPORATION CO., LTD.**  
101/19-24 Moo 20, Navanakorn Industrial Estate, Tambon Khlongnueng, Amphur Khlongluang,  
Pathumthani 12120, THAILAND  
Telephone : (66)2-909-0300
- Korea : **KUBOTA KOREA CO., LTD.**  
106-24 Mongsan-Ri, Mankyung-Up, Kimje-City, Chonrapuk-Do, KOREA  
Telephone : (82)-63-544-5822
- India : **KUBOTA AGRICULTURAL MACHINERY INDIA PVT. LTD.**  
Regus, Level 2 Altius, Olympia Tech Park, No.1 SIDCO Industrial Estate, Guindy, Chennai 600032, TN, India  
Telephone : (91)-44-4299-4237
- Vietnam : **KUBOTA VIETNAM CO., LTD.**  
Lot B-3A2-CN, My Phuoc 3 Industrial Park, Ben Cat District, Binh Duong Province, Vietnam  
Telephone : (84)-650-3577-507

KUBOTA Corporation

English (Australia)  
Code No. 3C793-9971-1

# OPERATOR'S MANUAL

# KUBOTA TRACTOR

**MODELS M6040  
M7040  
M8540  
M9540**



1AGAIDGAP001A

M  
6  
0  
4  
0  
·  
M  
7  
0  
4  
0  
·  
M  
8  
5  
4  
0  
·  
M  
9  
5  
4  
0

*READ AND SAVE THIS MANUAL*

# FOREWORD

Thank you very much for choosing the CAB model of the M series tractor. This operator's Manual covers the operation, inspection and preventive maintenance instructions that is specific to the oceania models. For other information and instructions, refer to the separately issued operator's manual for the sister models. (M6040, M7040, M8540, M9540)  
Please read both manuals carefully, to operate the machine properly and safety. Proper daily inspection, servicing and lubrication keeps your machine in good condition.

## KUBOTA Corporation is ...

Since its inception in 1890, KUBOTA Corporation has grown to rank as one of the major firms in Japan.

To achieve this status, the company has through the years diversified the range of its products and services to a remarkable extent, until today, 19 plants and 16,000 employees produce over 1,000 different items, large and small.

All these products and all the services which accompany them, however, are unified by one central commitment. KUBOTA makes products which, taken on a national scale, are basic necessities. Products which are indispensable, products intended to help individuals and nations fulfill the potential inherent in their environment. For KUBOTA is the Basic Necessities Giant.

This potential includes water supply, food from the soil and from the sea, industrial development, architecture and construction, transportation.

Thousands of people depend on KUBOTA's know-how, technology, experience and customer service. You too can depend on KUBOTA.

## SAFETY FIRST

This symbol, the industry's "Safety Alert Symbol", is used throughout this manual and on labels on the machine itself to warn of the possibility of personal injury. Read these instructions carefully. It is essential that you read the instructions and safety regulations before you attempt to assemble or use this unit.

 **DANGER :** Indicates an imminently hazardous situation which, if not avoided, will result in death or serious injury.

 **WARNING :** Indicates a potentially hazardous situation which, if not avoided, could result in death or serious injury.

 **CAUTION :** Indicates a potentially hazardous situation which, if not avoided, may result in minor or moderate injury.

**IMPORTANT :** Indicates that equipment or property damage could result if instructions are not followed.

**NOTE :** Gives helpful information.

# CONTENTS

▲ SAFE OPERATION .....	▲ -1
SPECIFICATIONS .....	1
SPECIFICATION TABLE .....	1
TRAVELING SPEEDS .....	3
INSTRUMENT PANEL AND CONTROLS .....	4
OPERATING THE TRACTOR .....	10
STARTING .....	10
Operator's Seat .....	10
Light Switch .....	11
Turn Signal / Hazard Light Switch .....	11
With Trailer Connector .....	11
PTO RPM / TRAVEL SPEED MONITOR .....	12
PTO Speed Display Mode Switching .....	12
PARKING .....	13
Parking Brake Lever .....	13
Gear Locked Parking Lever .....	13
OPERATING TECHNIQUES .....	14
Trailer Electrical Outlet .....	14
PTO .....	15
PTO OPERATION .....	15
PTO Gear Shift Lever .....	15
PTO Clutch Control Lever .....	15
PTO Clutch Control Switch .....	16
LCD Monitor Message .....	17
3-POINT HITCH & DRAWBAR .....	18
3-POINT HITCH .....	18
Remote Hitch UP / DOWN Lever .....	18
DRAWBAR .....	18
Adjusting Drawbar Length .....	18
Swing Drawbar .....	19
HYDRAULIC UNIT .....	20
REMOTE HYDRAULIC CONTROL SYSTEM .....	20
Remote Control Valve .....	20
Remote Control Valve Lever .....	20
TIRES, WHEELS AND BALLAST .....	22
TIRES .....	22
Inflation Pressure .....	22
Dual Tires .....	22
WHEEL ADJUSTMENT .....	22
Front Wheels (with 4 wheel drive) .....	23
Rear Wheels .....	24
MAINTENANCE .....	25

SERVICE INTERVALS .....	25
PERIODIC SERVICE.....	28
EVERY 100 HOURS .....	28
Adjusting Parking Brake Lever .....	28
Checking Gear Locked Parking Lever .....	28
SERVICE AS REQUIRED.....	28
Replacing Fuse.....	28
Replacing Light Bulb.....	30
OPTIONS.....	31



# SAFE OPERATION

Careful operation is your best insurance against an accident.

**Read and understand this manual carefully before operating the tractor.**

All operators, no matter how much experience they may have, should read this and other related manuals before operating the tractor or any implement attached to it. It is the owner's obligation to instruct all operators in safe operation.

## 1. BEFORE OPERATING THE TRACTOR

1. Know your equipment and its limitations. Read this entire manual before attempting to start and operate the tractor.
2. Pay special attention to the danger, warning and caution labels on the tractor.
3. KUBOTA recommends the use of a CAB or Roll Over Protective Structures (ROPS) and seat belt in almost all applications. This combination will reduce the risk of serious injury or death, should the tractor be upset. If the CAB or ROPS is loosened or removed for any reason, make sure that all parts are reinstalled correctly before operating the tractor.  
Never modify or repair a CAB or ROPS because welding, bending, drilling, grinding, or cutting may weaken the structure.  
A damaged CAB or ROPS structure must be replaced, not repaired or revised. If any structural member of the CAB or ROPS is damaged, replace the entire structure at your local KUBOTA Dealer.

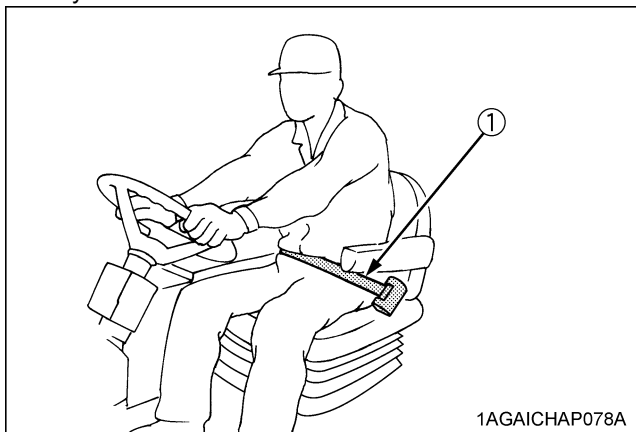

(1) Seat belt

4. Always use the seat belt if the tractor has a CAB or ROPS. Do not use the seat belt if there is no CAB or ROPS. Check the seat belt regularly and replace if frayed or damaged.

5. Do not operate the tractor or any implement attached to it while under the influence of alcohol, medication, controlled substances or while fatigued.
6. Carefully check the vicinity before operating tractor or any implement attached to it. Check for overhead clearance which may interfere with a CAB or ROPS. Do not allow any bystanders around or near tractor during operation.
7. Before allowing other people to use your tractor, explain how to operate and have them read this manual before operation.
8. Never wear loose, torn, or bulky clothing around tractor. It may catch on moving parts or controls, leading to the risk of an accident. Use additional safety items, e.g. hard hat, safety boots or shoes, eye and hearing protection, gloves, etc., as appropriate or required.
9. Do not allow passengers to ride on any part of the tractor at anytime. The operator must remain in the tractor seat during operation.
10. Check brakes, clutch, linkage pins and other mechanical parts for improper adjustment and wear. Replace worn or damaged parts promptly. Check the tightness of all nuts and bolts regularly. (For further details, see "MAINTENANCE" section.)
11. Keep your tractor clean. Dirt, grease, and trash build up may contribute to fires and lead to personal injury.
12. Use only implements meeting the specifications listed under "IMPLEMENT LIMITATIONS" in this manual or implements approved by KUBOTA.
13. Use proper weights on the front or rear of the tractor to reduce the risk of upsets. When using the front loader, put an implement or ballast on the 3-point hitch to improve stability. Follow the safe operating procedures specified in the implement or attachment manual.

14. The narrower the tread, the greater the risk of a tractor upset. For maximum stability, adjust the wheels to the widest practical tread width for your application. (See "TIRES, WHEELS AND BALLAST" section.)

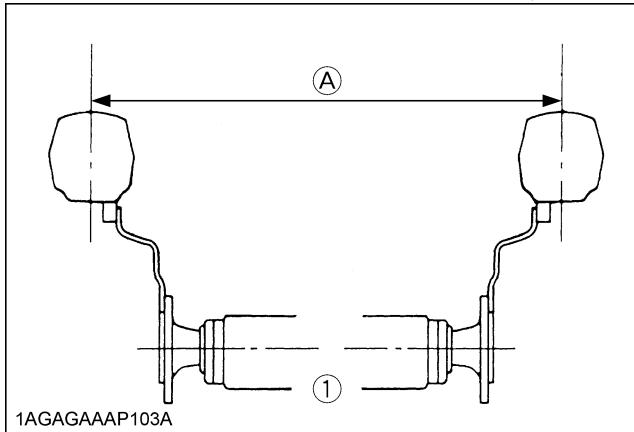

(1) Rear wheels

(A) Tread Width

15. Do not modify the tractor. Unauthorized modification may affect the function of the tractor, which may result in personal injury.

## 2. OPERATING THE TRACTOR

Operator safety is a priority. Safe operation, specifically with respect to overturning hazards, entails understanding the equipment and environmental conditions at the time of use. Some prohibited uses which can affect overturning hazards include traveling and turning with implements and loads carried too high etc. This manual sets forth some of the obvious risks, but the list is not, and cannot be, exhaustive. It is the operator's responsibility to be alert for any equipment or environmental condition that could compromise safe operation.

### ◆ Starting

1. Always sit in the operator's seat when starting engine or operating levers or controls. Adjust seat per instructions in the operating the tractor section. Never start engine while standing on the ground.
2. Before starting the engine, make sure that all levers (including auxiliary control levers) are in their neutral positions, that the parking brake is engaged, and that both the clutch and the Power Take-Off (PTO) are disengaged or "OFF".  
Fasten the seat belt if the tractor has a CAB, a fixed ROPS or a foldable ROPS in the upright and locked position.
3. Do not start engine by shorting across starter terminals or bypassing the safety start switch. Machine may start in gear and move if normal starting circuitry is bypassed.
4. Do not operate or idle engine in a non-ventilated area. Carbon monoxide gas is colorless, odorless, and deadly.

5. Check before each use that operator presence controls are functioning correctly. Test safety systems. (See "Checking Engine Start System" in "EVERY 50 HOURS" in "PERIODIC SERVICE" section.)  
Do not operate unless they are functioning correctly.

### ◆ Working

1. Pull only from the drawbar. Never hitch to axle housing or any other point except drawbar; such arrangements will increase the risk of serious personal injury or death due to a tractor upset.

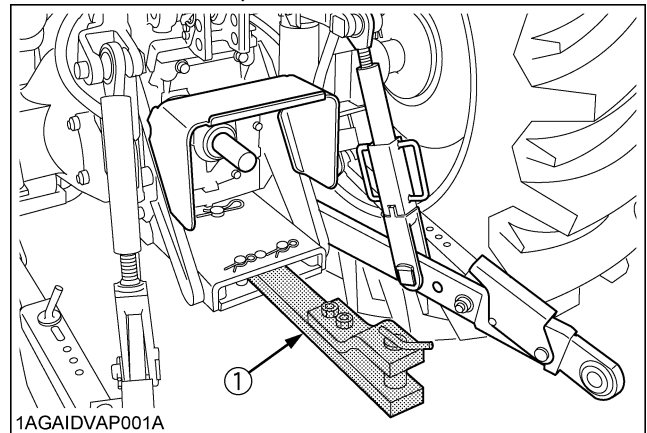

(1) Drawbar

2. Keep all shields and guards in place. Replace any that are missing or damaged.
3. Avoid sudden starts. To avoid upsets, slow down when turning, on uneven ground, and before stopping.
4. The tractor cannot turn with the rear wheel or 4-wheel differential locked and attempting to do so could be dangerous.
5. Do not operate near ditches, holes, embankments, or other ground surface features which may collapse under the tractor's weight. The risk of tractor upset is even higher when the ground is loose or wet. Tall grass can hide obstacles, walk the area first to be sure.
6. Watch where you are going at all times. Watch for and avoid obstacles. Be alert at row ends, near trees, and other obstructions.
7. When working in groups, always let the others know what you are going to do before you do it.
8. Never try to get on or off a moving tractor.
9. Do not stand between tractor and implement or trailed vehicle unless parking brake is applied.

### ◆ Safety for children

Tragedy can occur if the operator is not alert to the presence of children. Children generally are attracted to machines and the work they do.

1. Never assume that children will remain where you last saw them.
2. Keep children out of the work area and under the watchful eye of another responsible adult.
3. Be alert and shut your machine down if children enter the work area.

4. Never carry children on your machine. There is no safe place for them to ride. They may fall off and be run over or interfere with your control of the machine.
5. Never allow children to operate the machine even under adult supervision.
6. Never allow children to play on the machine or on the implement.
7. Use extra caution when backing up. Look behind and down to make sure area is clear before moving.
8. When parking your machine if at all possible park on a firm, flat and level surface; if not, park across a slope. Set the parking brake(s), lower the implements to the ground, remove the key from the ignition and lock the cab door (if equipped) and chock the wheels.

#### ◆ Operating on slopes

Slopes are a major factor related to loss-of-control and tip-over accidents, which can result in severe injury or death. All slopes require extra caution.

1. To avoid upsets, always back up steep slopes. If you cannot back up the slope or if you feel uneasy on it, do not operate on it. Stay off slopes too steep for safe operation.
2. Driving forward out of a ditch, mired condition or up a steep slope increases the risk of a tractor to be upset backward. Always back out of these situations. Extra caution is required with 4-wheel drive models because their increased traction can give the operator false confidence in the tractor's ability to climb slopes.
3. Keep all movement on slopes slow and gradual. Do not make sudden changes in speed, direction or apply brake and make sudden motions of the steering wheel.
4. Avoid disengaging the clutch or changing gears speed when climbing or going down a slope. If on a slope disengaging the clutch or changing gears to neutral could cause loss of control.
5. Special attention should be made to the weight and location of implements and loads as such will affect the stability of the tractor.
6. To improve stability on slope, set widest wheel tread as shown in "TIRES, WHEELS AND BALLAST" section.  
Follow recommendations for proper ballasting.

#### ◆ Driving the tractor on the road

1. Lock the 2 brake pedals together to help assure straight-line stops. Uneven braking at road speeds could cause the tractor to tip over.

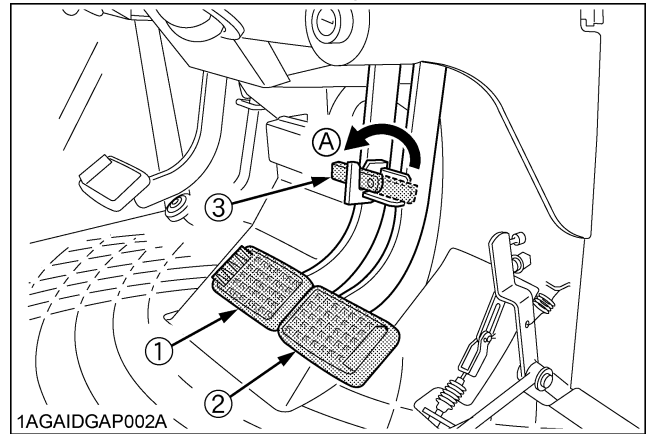

- (1) Brake Pedal (LH)      (A) Whenever travelling on the road  
 (2) Brake Pedal (RH)  
 (3) Brake Pedal Lock

2. Check the front wheel engagement. The braking characteristics are different between 2 and 4-wheel drive. Be aware of the difference and use carefully.
3. Always slow the tractor down before turning. Turning at high speed may tip the tractor over.
4. Turn the headlights on. Dim them when meeting another vehicle.
5. Drive at speeds that allow you to maintain control at all times.
6. Do not apply the differential lock while traveling at road speeds. The tractor may run out of control.
7. Avoid sudden motions of the steering wheel as they can lead to a dangerous loss of stability. The risk is especially great when the tractor is traveling at road speeds.
8. Do not operate an implement while the tractor is on the road. Lock the 3-point hitch in the raised position.

### 3. PARKING THE TRACTOR

1. Disengage the PTO, lower all implements to the ground, place all control levers in their neutral positions, set the parking brake, stop the engine, and remove the key.
2. Make sure that the tractor has come to a complete stop before dismounting.
3. Avoid parking on steep slopes, if at all possible park on a firm and level surface; if not, park across a slope with chock the wheels.  
Failure to comply with this warning may allow the tractor to move and could cause injury or death.

## 4. OPERATING THE PTO

1. Wait until all moving components have completely stopped before getting off the tractor, connecting, disconnecting, adjusting, cleaning, or servicing any PTO driven equipment.
2. Keep the PTO shaft cover in place at all times. Replace the PTO shaft cap when the shaft is not in use.

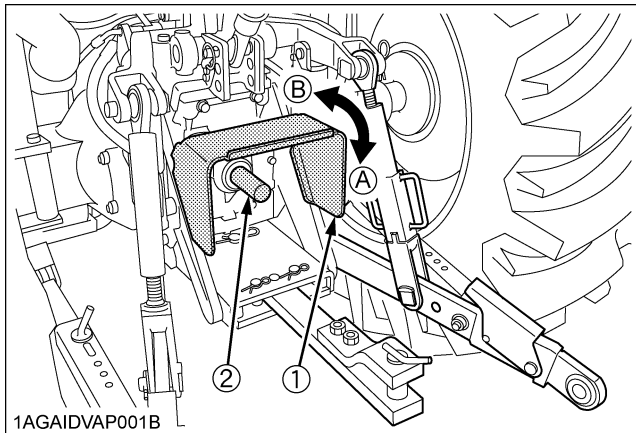

- (1) PTO Shaft cover (A) "NORMAL POSITION"  
 (2) PTO Shaft cap (B) "RAISED POSITION"

3. Before installing or using PTO driven equipment, read the manufacturer's manual and review the safety labels attached to the equipment.  
 To prevent PTO driven equipment from improper or unsafe use, select the lower speed (540rpm) unless the higher one is specifically recommended as safe by the equipment manufacture.
4. When operating stationary PTO driven equipment, always apply the tractor parking brake and place chocks behind and in front of the rear wheels. Stay clear of all rotating parts. Never step over rotating parts.

## 5. USING 3-POINT HITCH

1. Use the 3-point hitch only with equipment designed for 3-point hitch usage.
2. When using a 3-point hitch mounted implement, be sure to install the proper counterbalance weight on the front of the tractor.
3. When transporting on the road, set the implement lowering speed knob in the "LOCK" position to hold the implement in the raised position.

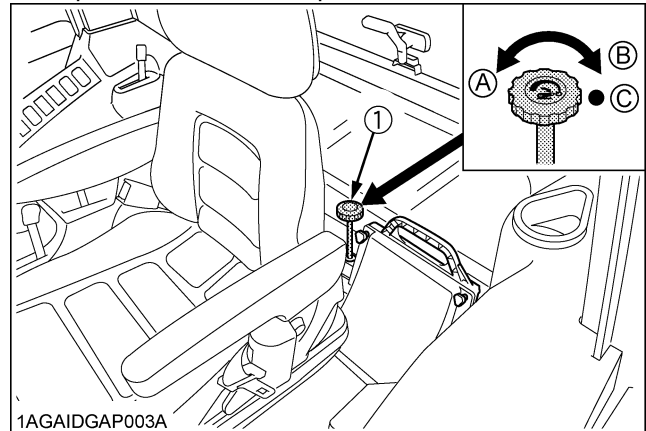

- (1) 3-point hitch lowering speed knob (A) "FAST"  
 (B) "SLOW"  
 (C) "LOCK"

## 6. SERVICING THE TRACTOR

Before servicing the tractor, park it on a firm, flat and level surface, set the parking brake, lower all implements to the ground, place the gear shift lever in neutral, stop the engine and remove the key.

1. Allow the tractor time to cool off before working on or near the engine, muffler, radiator, etc.
2. Do not remove radiator cap while coolant is hot. When cool, slowly rotate cap to the first stop and allow sufficient time for excess pressure to escape before removing the cap completely. If the tractor has a coolant recovery tank, add coolant or water to the tank, not the radiator. (See "Checking Coolant Level" in "DAILY CHECK" in "PERIODIC SERVICE" section.)
3. Always stop the engine before refueling. Avoid spills and overfilling.
4. Do not smoke when working around battery or when refueling. Keep all sparks and flames away from battery and fuel tank. The battery presents an explosive hazard, because it gives off hydrogen and oxygen especially when recharging.
5. Before "jump starting" a dead battery, read and follow all of the instructions. (See "JUMP STARTING" in "OPERATING THE ENGINE" section.)
6. Keep first aid kit and fire extinguisher handy at all times.



7. Disconnect the battery's ground cable before working on or near electric components.
8. To avoid the possibility of battery explosion, do not use or charge the refillable type battery if the fluid level is below the LOWER ( lower limit level ) mark. Check the fluid level regularly and add distilled water as required so that the fluid level is between the UPPER and LOWER levels.
9. To avoid sparks from an accidental short circuit, always disconnect the battery's ground cable (-) first and reconnect it last.

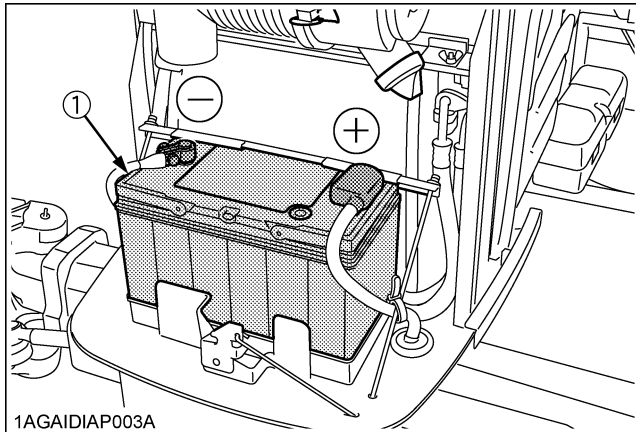

(1) Battery

10. Do not attempt to mount a tire on a rim. This should be done by a qualified person with the proper equipment.
11. Always maintain the correct tire pressure. Do not inflate tires above the recommended pressure shown in the operator's manual.

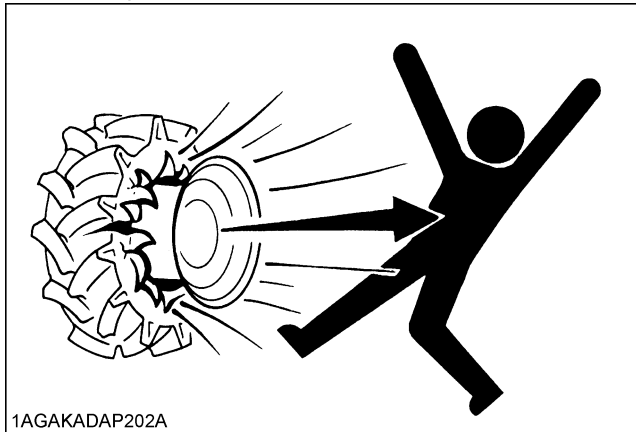

12. Securely support the tractor when either changing wheels or adjusting the wheel tread width.
13. Make sure that wheel bolts have been tightened to the specified torque.
14. Do not work under any hydraulically supported devices. They can settle, suddenly leak down, or be accidentally lowered. If it is necessary to work under tractor or any machine elements for servicing or adjustment, securely support them with stands or suitable blocking beforehand.

15. Escaping hydraulic fluid under pressure has sufficient force to penetrate skin, causing serious personal injury. Before disconnecting hydraulic lines, be sure to release all residual pressure. Before applying pressure to the hydraulic system, make sure that all connections are tight and that all lines, pipes, and hoses are free of damage.

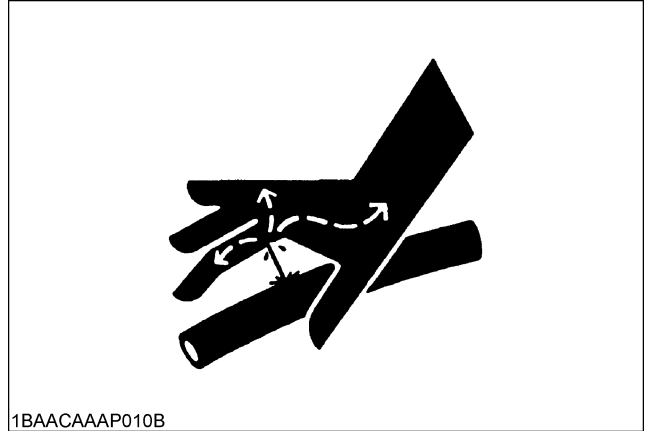

16. Fluid escaping from pinholes may be invisible. Do not use hands to search for suspected leaks; use a piece of cardboard or wood. Use of safety goggles or other eye protection is also highly recommended. If injured by escaping fluid, see a medical doctor at once. This fluid will produce gangrene or severe allergic reaction.

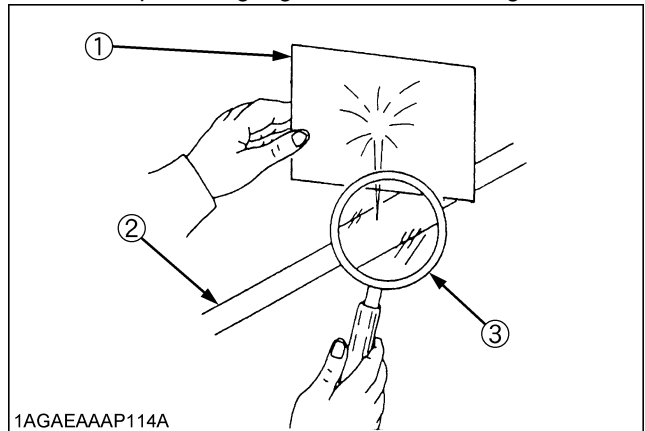

(1) Cardboard  
 (2) Hydraulic line  
 (3) Magnifying glass

7. DANGER, WARNING AND CAUTION LABELS

(1) Part No. 6C090-4958-2  
Do not get your hands close to engine fan and fan belt.



1AGAIAZAP110A

(2) Part No. 3N300-4958-1  
Do not touch hot surface like muffler, etc.

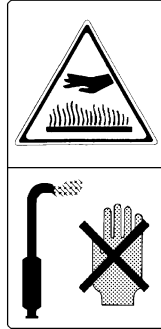

1AGAIAZAP071A

(3) Part No. 6C040-4741-1  
No fire



1AGAIAZAP104A

(4) Part No. 3A851-7295-1

<p><b>▲ CAUTION REFRIGERANT UNDER HIGH PRESSURE</b></p> <p>Improper service methods may cause injury. Air conditioning system should be serviced by qualified personnel. See Repair Manual.</p> <p>Refrigerant: HFC134a Max. 0.95kg (2.09lbs.) USE ONLY Min. 0.85kg (1.87lbs.)</p> <p>Oil: ND-OIL OR EQUIVALENT 8 SAE J-639</p> <p>MFD. BY DENSO CORPORATION JAPAN.</p>	<p><b>▲ ATTENTION REFRIGERANT SOUS HAUTE PRESSION</b></p> <p>Un entretien incorrect peut provoquer des blessures. Le système de climatisation doit être entretenu par une personne qualifiée. Voir le manuel de réparation.</p> <p>Refrigerant: HFC134a Max. 0.95kg (2.09lbs.) UNIQUEMENT Min. 0.85kg (1.87lbs.)</p> <p>Huile: ND-OIL OR EQUIVALENTE 8 SAE J-639</p> <p>FABRIQUE PAR DENSO CORPORATION JAPON.</p>
---	---

1AGAIDGAP074A

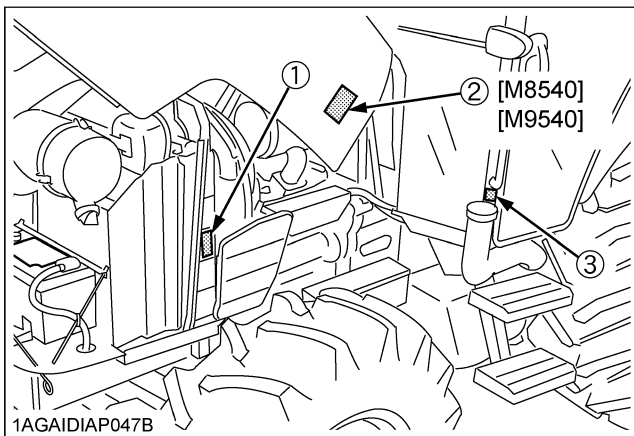

1AGAIDIAP047B

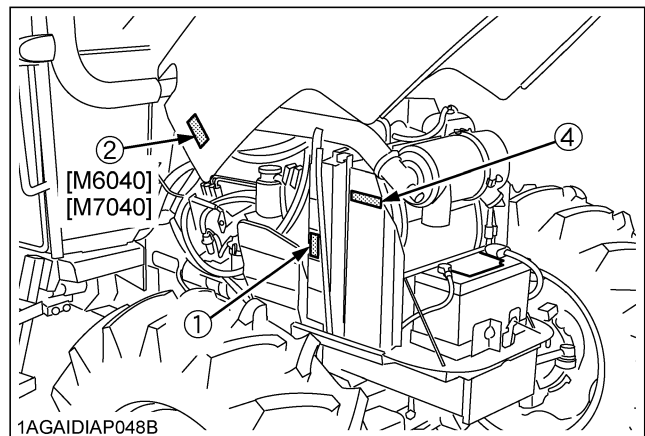

1AGAIDIAP048B

1AGAIDVAP003A

(1) Part No. 3Y205-9892-1

**⚠ DANGER/POISON**

 <b>SHIELD EYES.</b> EXPLOSIVE GASES CAN CAUSE BLINDNESS OR INJURY.	 <b>NO SPARKS</b> FLAMES SMOKING	 <b>SULFURIC ACID</b> CAN CAUSE BLINDNESS OR SEVERE BURNS.
--	---	--

KEEP OUT OF REACH OF CHILDREN.  
DO NOT TIP. DO NOT OPEN BATTERY.

**FLUSH EYES IMMEDIATELY WITH WATER.** **GET MEDICAL HELP FAST.**

**PROPOSITION 65 WARNING**  
 BATTERY POSTS, TERMINALS,  
 AND RELATED ACCESSORIES  
 CONTAIN LEAD AND LEAD COMPOUNDS,  
 CHEMICALS KNOWN  
 TO THE STATE OF CALIFORNIA  
 TO CAUSE CANCER AND  
 REPRODUCTIVE HARM.  
 WASH HANDS AFTER HANDLING.

DK 85330

**105E41R 12V**

AMP. HR (5HR)	80
AMP. HR (20HR)	100
RESERVE CAPACITY (MIN)	160
BCI CCA	900
EN CCA	800

SOC  
 INDICATOR

CHARGE

REPAIR

BATTERY

**Pb**

RECYCLE

(2) Part No. TA040-4965-2 [M6040, M7040]

**⚠ DANGER**

**TO AVOID POSSIBLE INJURY OR DEATH FROM A MACHINE RUNAWAY.**

- Do not start engine by shorting across starter terminals or bypassing the safety start switch. Machine may start in gear and move if normal starting circuitry is bypassed.
- Start engine only from operator's seat with transmission and PTO OFF. Never start engine while standing on the ground.

1AGAIAZAP009A

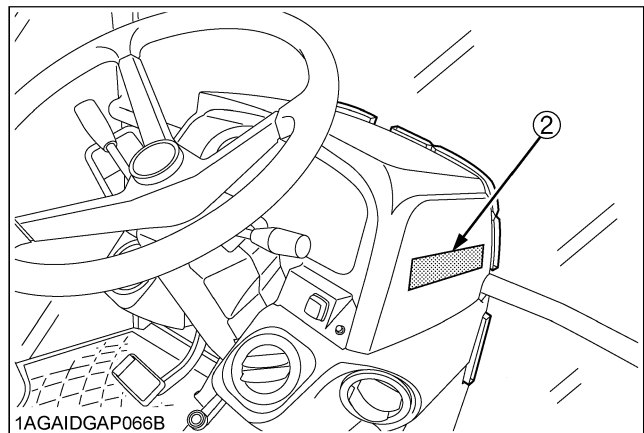
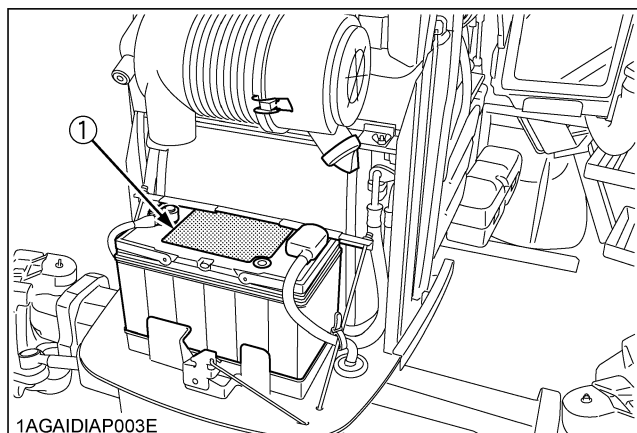

1AGAIDIAP055B

(1) Part No. 3F240-9857-1 [Hydraulic shuttle model]

 <h2 style="margin: 0;">WARNING</h2>
<p>To avoid free wheeling when shifting the shuttle lever while on a slope : Stop completely by using the brake and by depressing the clutch pedal. Start off after selecting shuttle direction by releasing the clutch pedal.</p>

1AGAIBDAP039A

(2) Part No. TA040-4965-2 [M8540, M9540]

	 <h2 style="margin: 0;">DANGER</h2>
	<p><b>TO AVOID POSSIBLE INJURY OR DEATH FROM A MACHINE RUNAWAY.</b></p> <ol style="list-style-type: none"> <li>1. Do not start engine by shorting across starter terminals or bypassing the safety start switch. Machine may start in gear and move if normal starting circuitry is bypassed.</li> <li>2. Start engine only from operator's seat with transmission and PTO OFF. Never start engine while standing on the ground.</li> </ol>

1AGAIAZAP009A

(3) Part No. 6C150-4743-1 [Hydraulic shuttle model]

 <h2 style="margin: 0;">WARNING</h2>	<p><b>BEFORE DISMOUNTING TRACTOR:</b></p> <ol style="list-style-type: none"> <li>1. ALWAYS SET PARKING BRAKE. Leaving transmission in gear with the engine stopped will not prevent tractor from rolling.</li> <li>2. PARK ON LEVEL GROUND WHENEVER POSSIBLE. If parking on a slope, position tractor across the slope.</li> <li>3. LOWER ALL IMPLEMENTS TO THE GROUND.</li> <li>4. STOP THE ENGINE.</li> </ol>
	

1AGAIBDAP040A

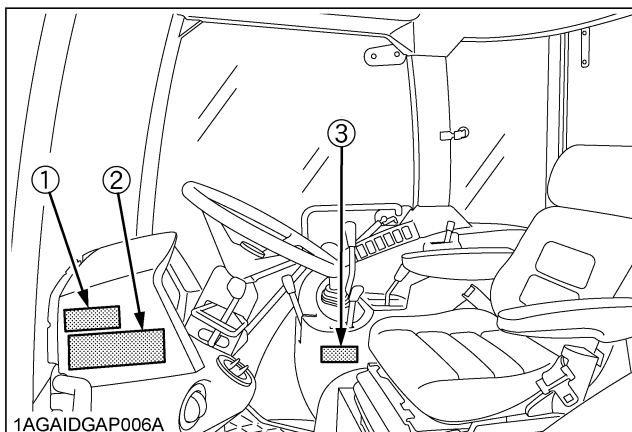

1AGAIDGAP006A

1AGAIDGAP072B

(1) Part No. 3F240-9836-2

**▲ CAUTION****TO AVOID PERSONAL INJURY:**

1. Read and understand the operator's manual before operation.
2. Before starting the engine, make sure that everyone is at a safe distance from tractor and the PTO is off.
3. Do not allow passengers on the tractor at any time.
4. Before allowing other people to use the tractor, have them read the operator's manual.
5. Check the tightness of nuts and bolts regularly.
6. Keep all shields in place and stay away from all moving parts.
7. Lock the two brake pedals together before driving on the road.
8. Slow down for turns, or rough roads, or when applying individual brakes.
9. On public roads use SMV emblem and hazard lights, if required by local traffic and safety regulations.
10. Pull only from the drawbar.
11. Before dismounting, lower the implement to the ground, set the parking brake, stop the engine and remove the key.
12. Securely support tractor and implements before working underneath.

1AGAICHAP113A

(2) Part No. TA040-4902-1

**▲ WARNING**

**TO AVOID INJURY OR DEATH FROM ROLL-OVER:**  
Always use seat belt when driving.

1AGAMAOAP078A

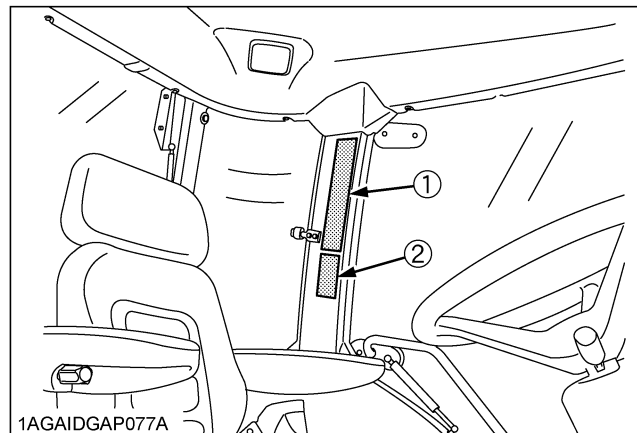

1AGAIDGAP077A

1AGAIDGAP071A

(1) Part No. 3P305-9856-1



1AGAICVAP046E

(2) Part No. TA040-4935-1



1AGAIAZAP056A

(3) Part No. TA040-4959-3

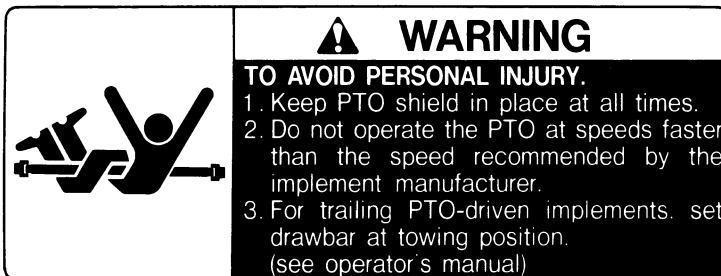

1AGAIAZAP116A

(4) Part No. 3F240-9819-1

**[With Dual Speed model]**

Do not stand by IMPLEMENT or between implement and tractor while operating remote hitch switch.

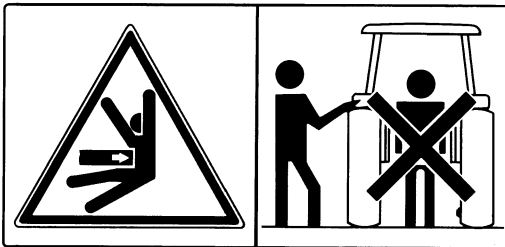

1AGAIBIAP1770

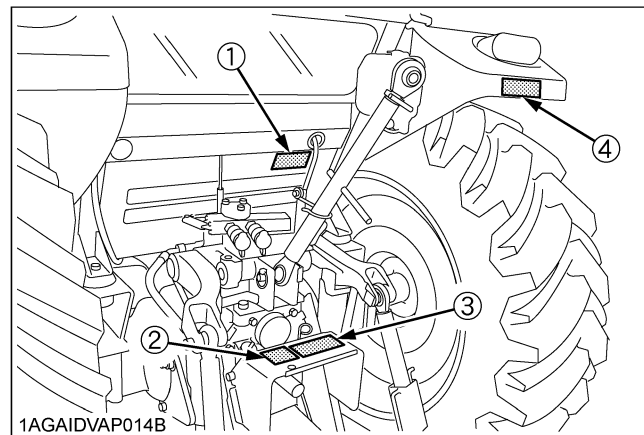

1AGAIIDVAP014B

1AGAIIDVAP015B

## 8. CARE OF DANGER, WARNING AND CAUTION LABELS

1. Keep danger, warning and caution labels clean and free from obstructing material.
2. Clean danger, warning and caution labels with soap and water, dry with a soft cloth.
3. Replace damaged or missing danger, warning and caution labels with new labels from your local KUBOTA Dealer.
4. If a component with danger, warning and caution label(s) affixed is replaced with new part, make sure new label(s) is (are) attached in the same location(s) as the replaced component.
5. Mount new danger, warning and caution labels by applying on a clean dry surface and pressing any bubbles to outside edge.

# SPECIFICATIONS

## SPECIFICATION TABLE

Model			M6040	M7040		M8540	M9540
			4WD	2WD	4WD	4WD	4WD
Engine	Model		V3307-DI			V3800-DI-T [V3800-DI-TE3]	
	Type		Direct Injection, liquid cooled 4 cylinder diesel				
	Number of cylinders		4				
	Total displacement	cm <sup>3</sup>	3331			3769	
	Bore and stroke	mm	94 x 120			100 x 120	
	Rated speed	rpm	2600				
	Net power *1	kW	46.2	50.7	62.6	70.8	
	PTO power *1 (factory observed)	kW	41.0	46.2	56.0	62.7	
	Maximum torque	N-m / rpm	213 / 1300 to 1500	232 / 1300 to 1500	283 / 1400 to 1600	316 / 1400 to 1600 [314 / 1500 to 1700]	
	Battery capacity		12V, RC: 160 min, CCA 900A				
	Fuel		Diesel fuel No.1 (below-10 °C ), Diesel fuel No.2 (above-10 °C )				
	Fuel tank capacity	L	90			110	
	Engine oil capacity	L	11			10.7	
Coolant capacity	L	8			9.0		
Dimensions	Overall length		mm	3505	3625	3505	3760 [3955]
	Overall width (minimum tread)		mm	1860			2010
	Overall height		mm	2555	2565		2570 [2650]
	Wheel base		mm	2110	2145	2110	2250
	Tread	Front	mm	1420, 1440, 1520	1420 to 1820	1420, 1440, 1520	1540, 1560, 1600 [1540, 1560, 1660]
		Rear	mm	1420 to 1720			1540 to 1940 [1498, 1598, 1698, 1798, 1898]
	Minimum ground clearance		mm	430 (Fuel tank stay)	440 (Fuel tank stay)		450 (Drawbar bracket)
Weight		kg	2430	2380	2440	2800	

## 2 SPECIFICATIONS

Model			M6040	M7040		M8540	M9540	
			4WD	2WD	4WD	4WD	4WD	
Traveling system	Standard tire size	Front tires	9.5-24	7.5-16	9.5-24	12.4-24 [360/70R24]		
		Rear tires *2	16.9-28	16.9-30		18.4-30 [480/70R34]		
	Clutch		Dry single plate / Multiple wet disks [Hydraulic multiple wet disks]					
	Steering		Hydraulic Power Steering					
	Braking system		Multiple wet disks mechanical			Hydraulic wet disks		
	Differential		Bevel gears with differential lock (Rear)					
Hydraulic unit	Hydraulic control system		Position, draft (top link sensing) & mix control					
	Pump capacity	L / min	41.6			64.3		
	3-point hitch		Category 1 and 2			Category 2		
	Max. lifting force	At lifting points *3	kg	1900 At lower link end with links horizontal			2500, 3900 with hydraulic High Capacity Lift Cylinders	
		24 in. behind lifting point	kg	1500			2100, 3300 with hydraulic High Capacity Lift Cylinders	
	Remote hydraulic control		2 standard (3rd & flow control valve optional)					
	System pressure	MPa (kgf/cm <sup>2</sup> )	19.1 (195)			19.6 (200)		
	Traction system		Swinging drawbar, adjustable in direction					
PTO	Live PTO (Independent)	Direction of turning		Clockwise, viewed from tractor rear				
		PTO/ Engine speed	rpm	540 / 2160 540E / 1825			540 / 2035 540E / 1519	

The company reserves the right to change the specifications without notice.

**NOTE:** \*1 Manufacturer's estimate

\*2 Cast iron disks available for wheels.

\*3 At lower link end with links horizontal.

A parenthesis [ ] shows a M9540 DUAL SPEED model.



# TRAVELING SPEEDS

(At rated engine rpm)

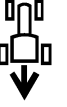
Model			M6040	M7040	M8540 / M9540	M9540	
Tire size (Rear)			16.9-28	16.9-30	18.4-30	480/70R34	
Transmission type			without Dual speed			with Dual speed	
						Hi	Lo
Shuttle shift lever	Range gear shift lever	Main gear shift lever	km/h	km/h	km/h	km/h	km/h
Forward 	CREEP	1	0.34	0.35	0.42	0.46	0.39
		2	0.48	0.50	0.54	0.59	0.50
		3	0.64	0.67	0.71	0.78	0.65
		4	1.0	1.1	0.91	0.99	0.84
		5	---	---	1.12	1.23	1.04
		6	---	---	1.35	1.48	1.25
	L	1	2.4	2.5	2.6	3.0	2.5
		2	3.4	3.5	3.4	3.8	3.2
		3	4.5	4.7	4.5	5.0	4.2
		4	7.4	7.7	5.7	6.4	5.4
		5	---	---	7.1	8.0	6.7
		6	---	---	8.5	9.6	8.1
	H	1	9.3	9.6	10.4	11.5	9.6
		2	13.1	13.6	13.4	14.7	12.4
		3	17.6	18.2	17.7	19.4	16.3
		4	28.6	29.7	22.6	24.8	20.9
		5	---	---	28.0	30.8	25.9
		6	---	---	33.7	37.0	31.1
Reverse 	CREEP	1	0.34	0.36	0.42	0.46	0.39
		2	0.49	0.51	0.53	0.60	0.50
		3	0.65	0.68	0.70	0.79	0.66
		4	1.1	1.1	0.90	1.01	0.85
		5	---	---	1.11	1.25	1.05
		6	---	---	1.34	1.50	1.26
	L	1	2.4	2.5	2.6	3.0	2.5
		2	3.4	3.6	3.4	3.9	3.3
		3	4.6	4.8	4.4	5.1	4.3
		4	7.5	7.8	5.7	6.5	5.5
		5	---	---	7.0	8.1	6.8
		6	---	---	8.5	9.7	8.2
	H	1	9.4	9.7	10.4	11.6	9.8
		2	13.3	13.8	13.3	14.9	12.5
		3	17.8	18.5	17.5	19.6	16.5
		4	29.0	30.1	22.5	25.1	21.1
		5	---	---	27.8	31.1	26.2
		6	---	---	33.4	37.5	31.5

The company reserves the right to change the specifications without notice

# INSTRUMENT PANEL AND CONTROLS

■ Instrument Panel, Switches and Hand Controls

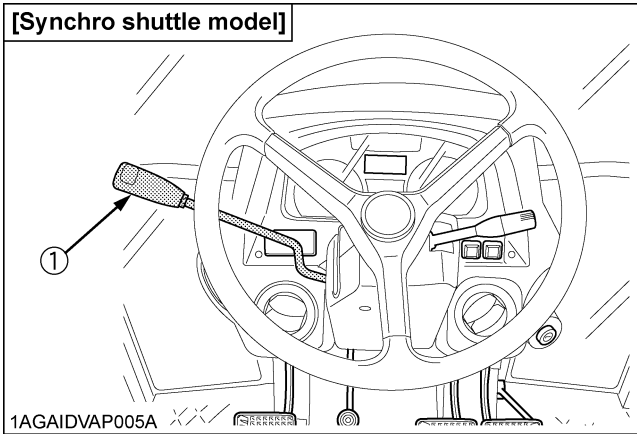
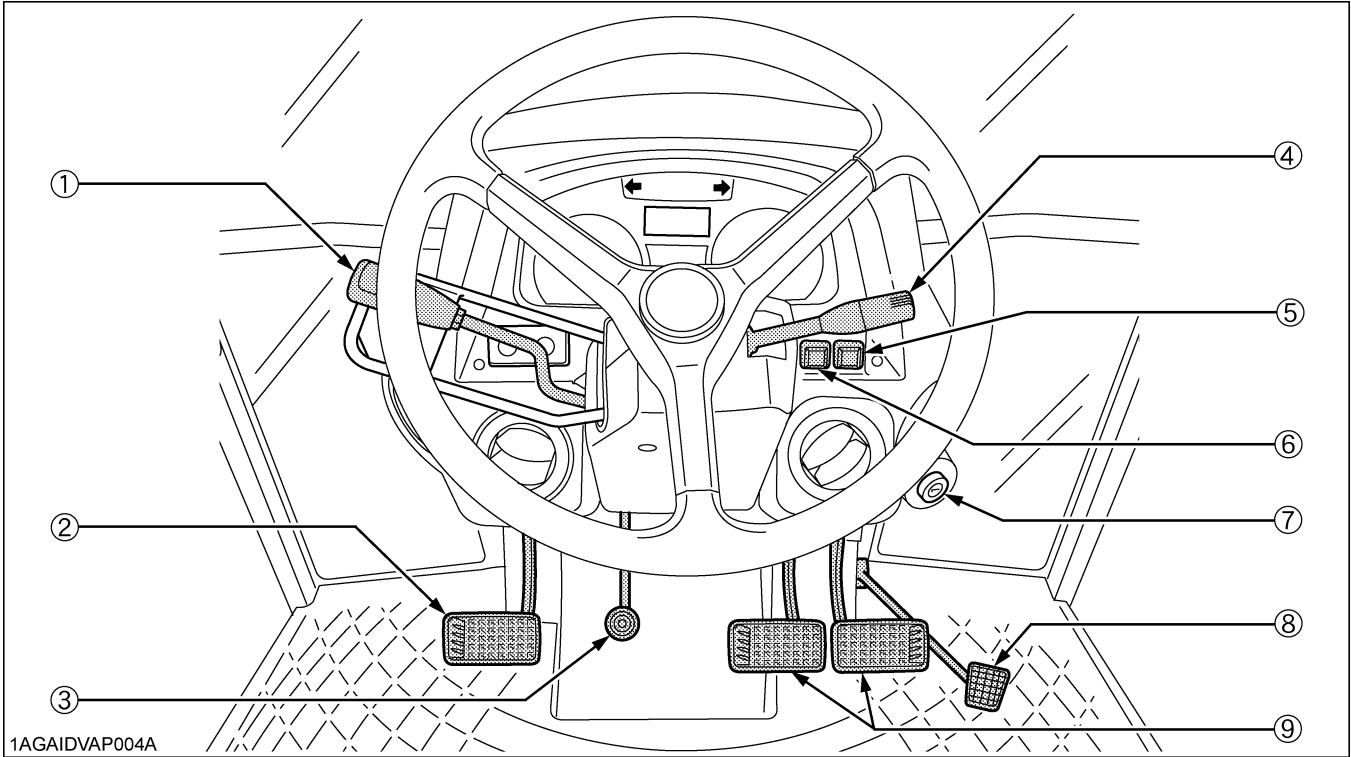

ILLUSTRATED CONTENTS

(1) Hydraulic-shuttle shift lever [Hydraulic shuttle model] .....	*
(1) Synchro-shuttle shift lever [Synchro shuttle model] .....	*
(2) Clutch pedal .....	*
(3) Tilt pedal .....	*
(4) Turn signal / Head light switch .....	11, 11
(5) Hazard light switch .....	11
(6) Horn button .....	*
(7) Key switch .....	*
(8) Foot throttle .....	*
(9) Brake pedal .....	*

\* See operator's manual issued separately for the sister model. [M6040, M7040, M8540, M9540]

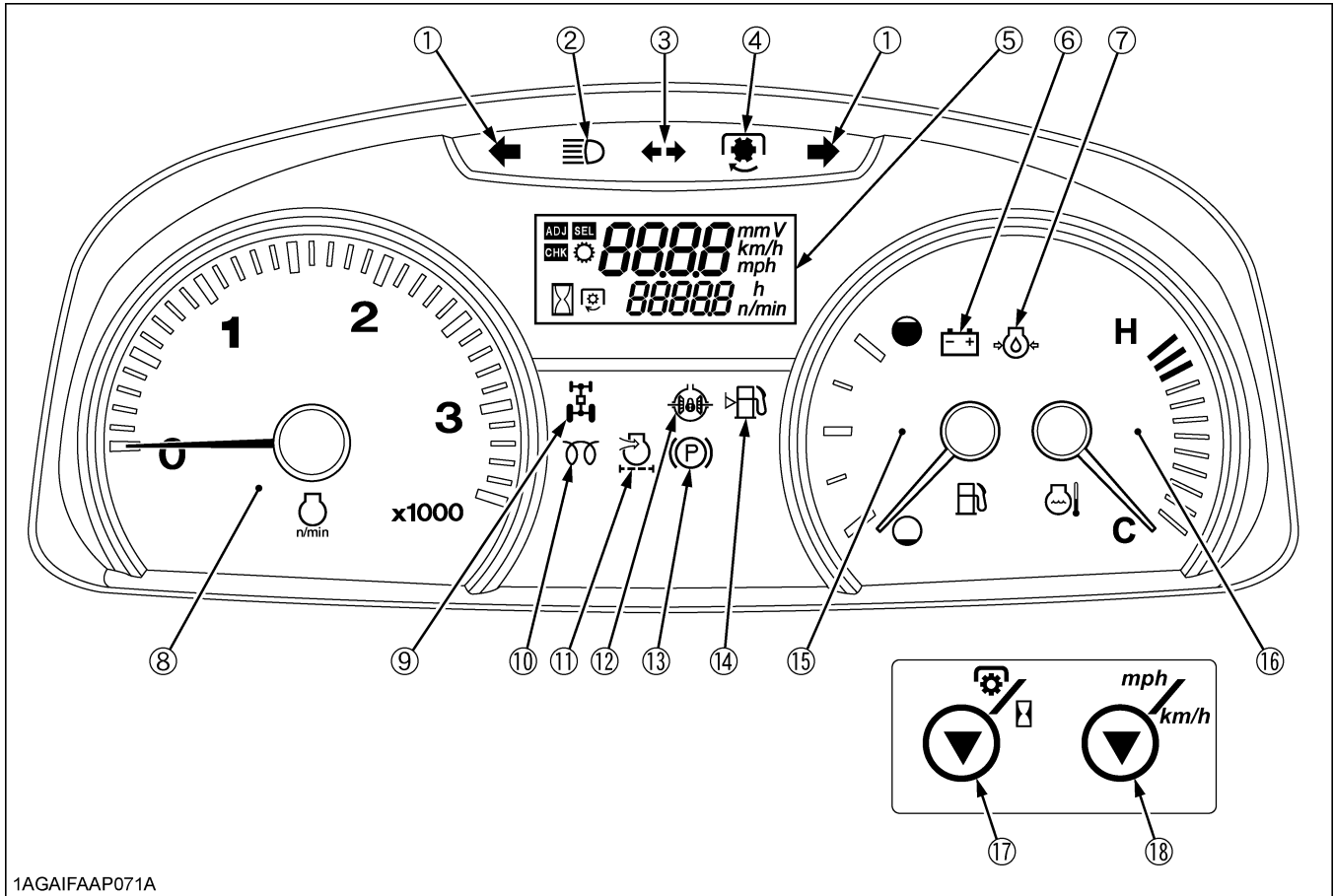

1AGAIFAAP071A

ILLUSTRATED CONTENTS

ILLUSTRATED CONTENTS

(1) Hazard / Turn signal indicator ..... 11

(2) High beam indicator ..... ---

(3) Trailer indicator ..... 11

(4) PTO clutch indicator ..... 15, 16

(5) Liquid crystal display ..... \*

(6) Electrical charge indicator ..... \*

(7) Engine oil pressure indicator ..... \*

(8) Tachometer ..... \*

(9) 4WD indicator ..... \*

(10) Heater indicator ..... \*

(11) Air cleaner indicator ..... ---

(12) Rear wheel differential lock indicator ..... \*

(13) Parking brake indicator ..... 13

(14) Fuel level indicator ..... \*

(15) Fuel gauge ..... \*

(16) Coolant temperature gauge ..... \*

(17) PTO / Hour meter select switch ..... \*

(18) Travel speed select switch ..... \*

**NOTE :**

- Only the M9540 dual speed model is equipped with an indicator (2) (3) (11) (12) and (13).
- Air cleaner indicator (11)  
If the air cleaner clogged, the warning lamp in the Easy Checker(TM) will come on.  
If this should happen during operation, clean the air cleaner element.  
(See "Cleaning Air Cleaner Primary Element" in "EVERY 100 HOURS" in "PERIODIC SERVICE" section.)

■ Foot and Hand Controls

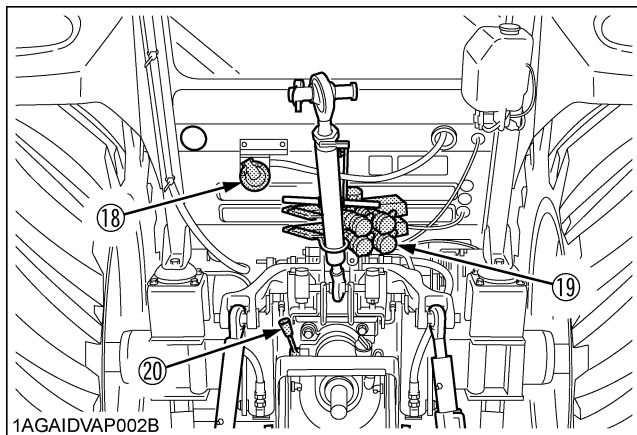
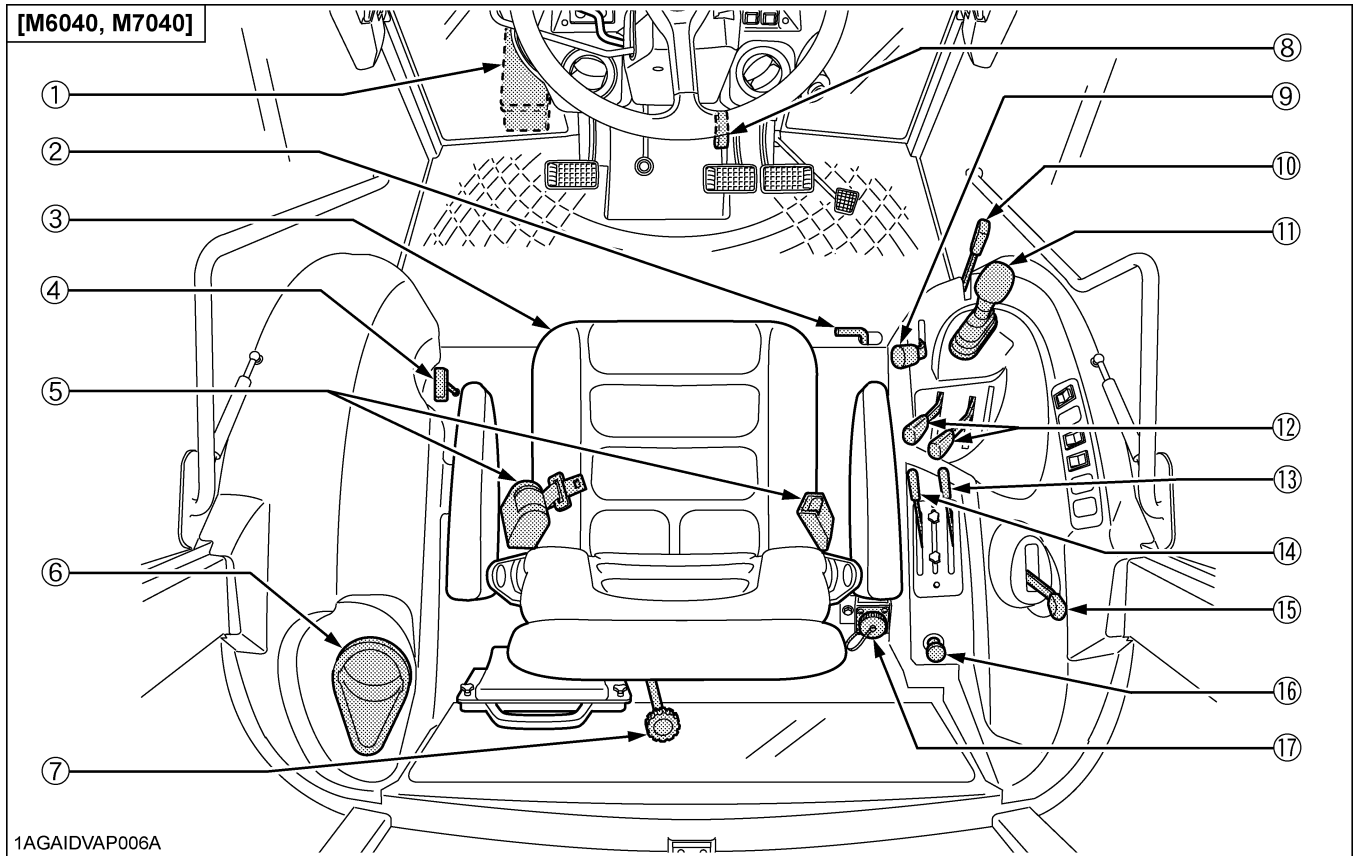

ILLUSTRATED CONTENTS

(1) Tool box .....	--
(2) Differential lock pedal .....	*
(3) Operator's seat .....	*
(4) Front wheel drive lever .....	*
(5) Seat belt .....	*
(6) Cup holder .....	--
(7) 3-Point hitch lowering speed knob .....	*
(8) Parking brake lever .....	*
(9) Hand throttle lever .....	*
(10) Range gear shift lever .....	*
(11) Main gear shift lever .....	*
(12) Remote control valve lever .....	20
(13) Position control lever .....	*
(14) Draft control lever .....	*
(15) PTO clutch control lever .....	15
(16) Cigarette lighter .....	*
(17) Electrical outlet .....	*
(18) Trailer electrical outlet .....	14
(19) Remote control valve coupler .....	*
(20) PTO gear shift lever .....	15

◆ without Dual Speed model

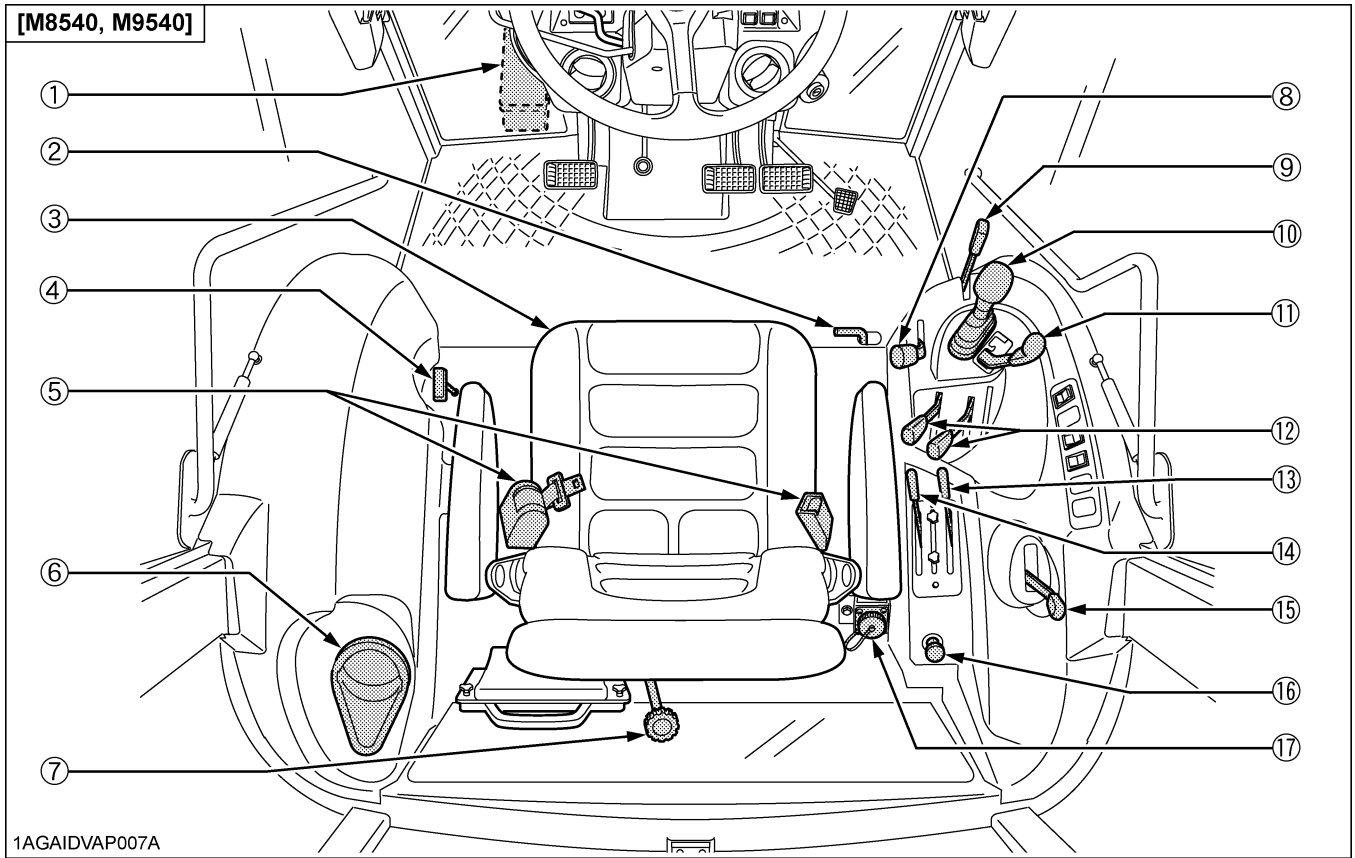

1AGAIDVAP007A

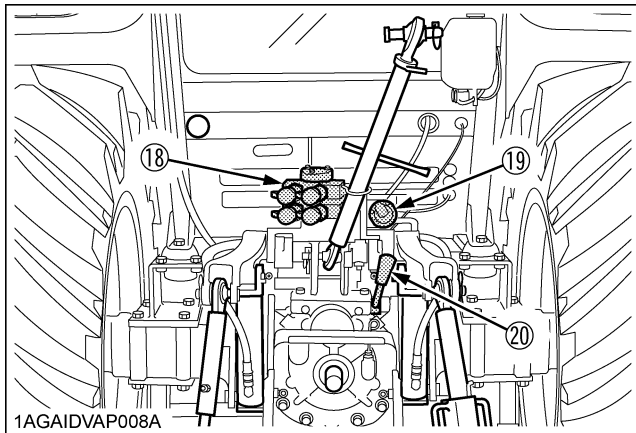

1AGAIDVAP008A

ILLUSTRATED CONTENTS

(1) Tool box .....	--
(2) Differential lock pedal .....	*
(3) Operator's seat .....	*
(4) Front wheel drive lever .....	*
(5) Seat belt .....	*
(6) Cup holder .....	--
(7) 3-Point hitch lowering speed knob .....	*
(8) Hand throttle lever .....	*
(9) Range gear shift lever .....	*
(10) Main gear shift lever .....	*
(11) Parking brake lever .....	*
(12) Remote control valve lever .....	20
(13) Position control lever .....	*
(14) Draft control lever .....	*
(15) PTO clutch control lever .....	15
(16) Cigarette lighter .....	*
(17) Electrical outlet .....	*
(18) Remote control valve coupler .....	*
(19) Trailer electrical outlet .....	14
(20) PTO gear shift lever .....	15

◆ with Dual Speed model

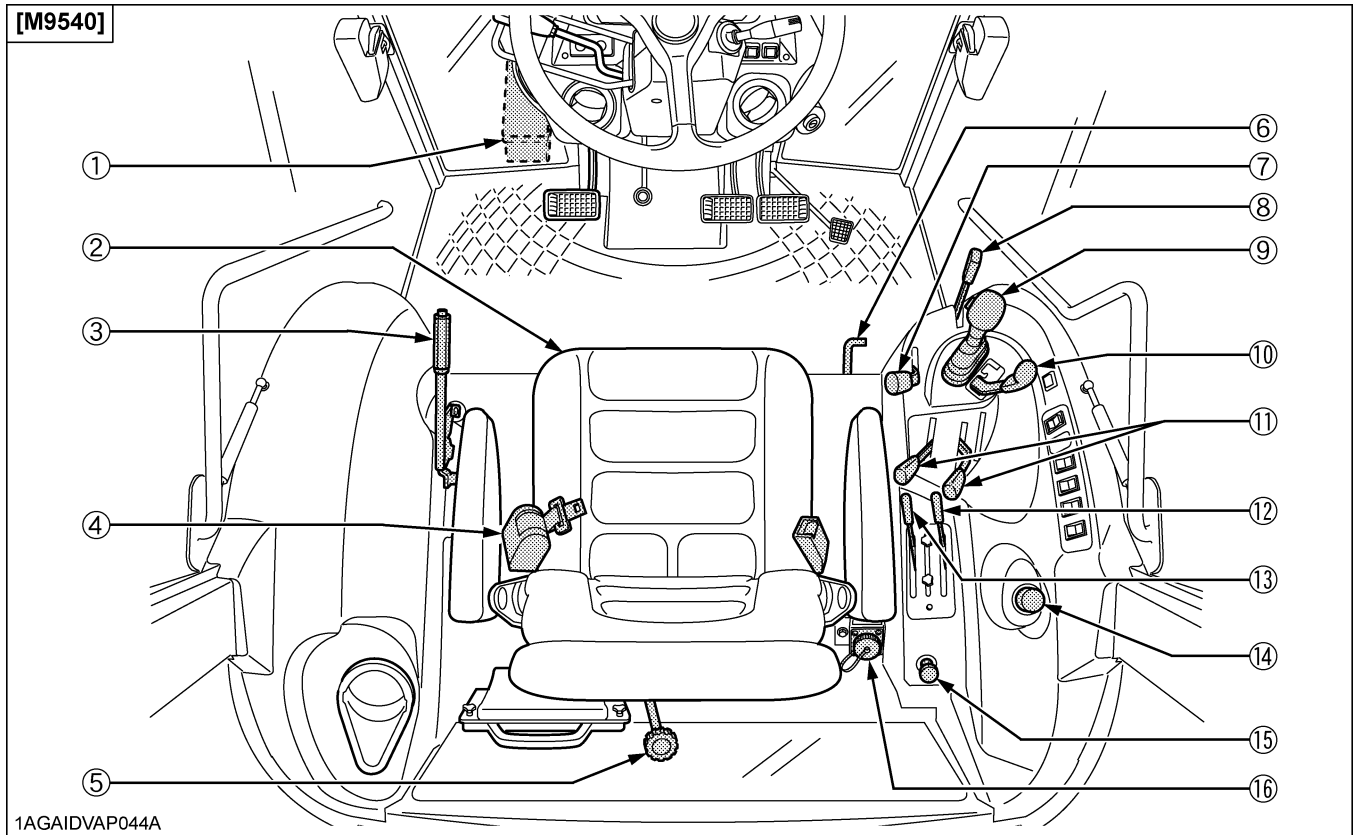

1AGAIDVAP044A

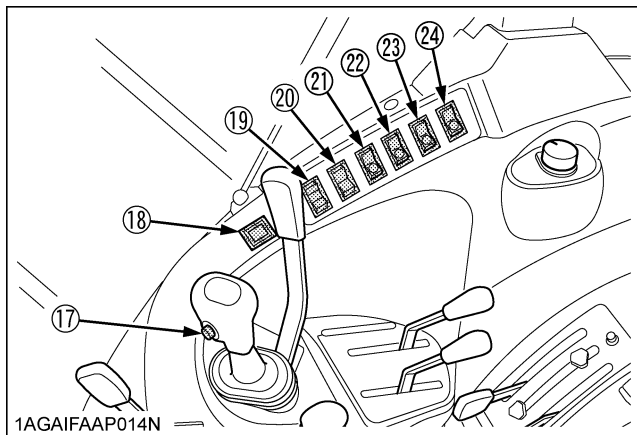

1AGAIFAAP014N

ILLUSTRATED CONTENTS

(1) Tool box .....	---
(2) Operator's seat .....	10
(3) Parking brake lever .....	13
(4) Seat belt .....	*
(5) 3-Point hitch lowering speed knob .....	*
(6) Differential lock pedal .....	*

ILLUSTRATED CONTENTS

(7) Hand throttle lever .....	*
(8) Range gear shift lever .....	*
(9) Main gear shift lever .....	*
(10) Gear locked parking lever .....	13
(11) Remote control valve lever .....	20
(12) Position control lever .....	*
(13) Draft control lever .....	*
(14) PTO clutch control switch .....	16
(15) Cigarette lighter .....	*
(16) Electrical outlet .....	*
(17) Dual speed shift switch .....	*
(18) Dual speed indicator .....	*
(19) Front wiper / Washer switch .....	*
(20) Rear wiper / Washer switch .....	*
(21) Front wheel drive switch (4WD) .....	*
(22) Front work light switch .....	*
(23) Rear work light switch .....	*
(24) Beacon light switch .....	*

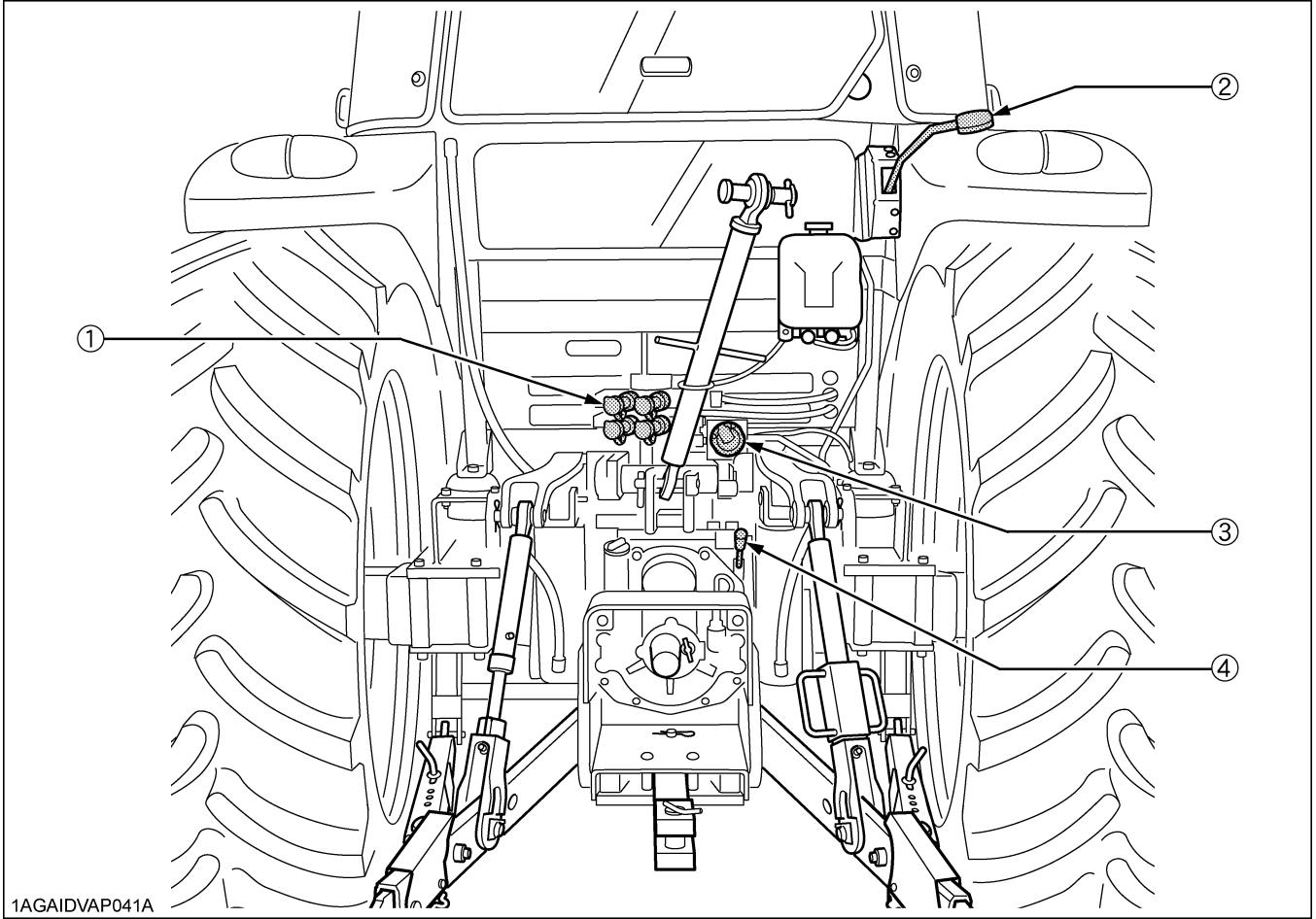

1AGAI DVAP041A

ILLUSTRATED CONTENTS

(1) Remote control valve coupler .....	*
(2) Remote hitch Up / Down lever .....	18
(3) Trailer electrical outlet .....	14
(4) PTO gear shift lever .....	15

# OPERATING THE TRACTOR

## STARTING

[With Dual Speed model]

### Operator's Seat



### CAUTION

To avoid personal injury:

- Make adjustments to the seat only while the tractor is stopped.
- Make sure that the seat is completely secured after each adjustment.
- Do not allow any person other than the operator to ride on the tractor.

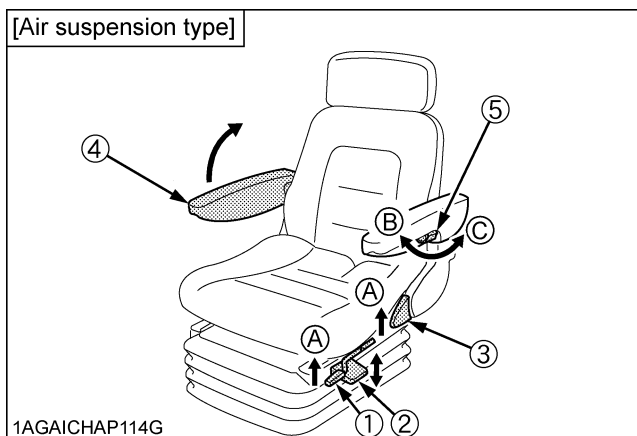

- |                                  |                         |
|----------------------------------|-------------------------|
| (1) Travel adjust lever          | (A) "UNLOCK"            |
| (2) Weight / Height adjust lever | (B) "TO INCREASE ANGLE" |
| (3) Backrest tilt adjust lever   | (C) "TO DECREASE ANGLE" |
| (4) Arm rest                     |                         |
| (5) Arm rest angle adjust knob   |                         |

#### ◆ Travel adjustment

Unlock the travel adjust lever and slide the seat backward or forward, as required. The seat will lock in position when the lever is released.

#### ◆ Weight and Height adjustment

Turn on the key switch. The seat should be adjusted for the operator's weight by briefly pulling up or pushing down the weight / height adjust lever with the tractor in a stationary position and the operator sitting on the seat. The seat can be adjusted in its adjustable range.

#### NOTE :

- If the seat is lowered below the adjustable range, it automatically comes up to the lower limit of the adjustable range just when the weight / height adjust lever is released.
- When turning on the key switch, the seat may slightly move up depending on a preset seat position (height).

#### IMPORTANT :

- In order to avoid damage of the seat, do not operate the weight / height adjust lever for more than 1 minute.

#### ◆ Tilt adjustment

Pull the backrest tilt adjust lever and tilt the backrest to the desired position.

#### ◆ Arm rest

Armrest may be set at upright position if desired.

#### ◆ Arm rest angle adjustment

Turn the arm rest angle adjust knob to the desired angle.

#### IMPORTANT :

- After adjusting the operator's seat, be sure to check to see that the seat is properly locked,



## ■ Light Switch

Turn the light switch clockwise, and the following lights are activated on the switch position.

- OFF..... Head lights OFF.
- ☉..... Head lights dimmed, low beam.
- ☉..... Head lights ON, high beam.

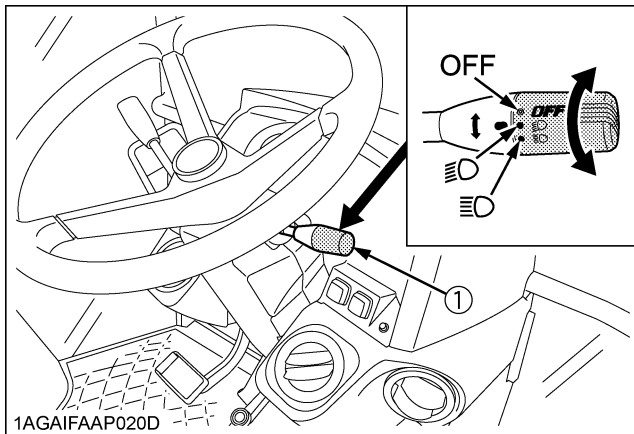

(1) Head light switch

## ■ Turn Signal / Hazard Light Switch

### ◆ Turn Signal Light Switch

To indicate a right turn, turn the turn signal light switch clockwise. To indicate a left turn, turn the turn signal light switch counter-clockwise. The corresponding right and left turn signal lights and indicator on the instrument panel will flash. Turn signal is active when key switch is in the "ON" position.

#### NOTE :

- Be sure to return switch to center position after turning.

### ◆ Hazard Light Switch

When hazard light switch is pushed, the hazard lights flash along with the indicator on the instrument panel. Press the hazard light switch again to turn off the light.

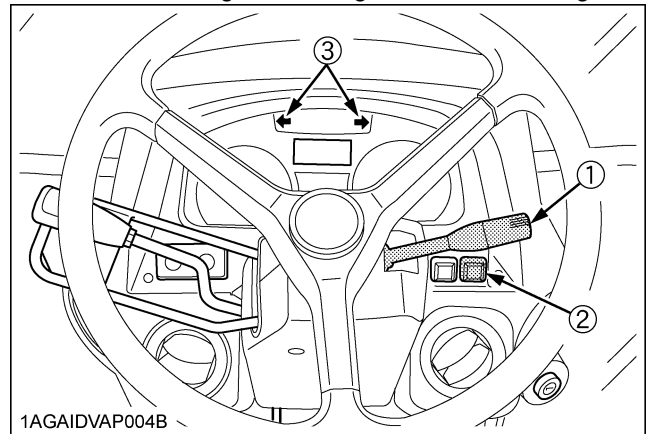

- (1) Turn signal light switch
- (2) Hazard light switch
- (3) Hazard / Turn signal indicator

## ■ With Trailer Connector

When you operate the turn signal light switch with the trailer power connector connected, the trailer indicator in the instrumental panel also starts flashing along with the turn signal indicator.

## PTO RPM / TRAVEL SPEED MONITOR

### ■ PTO Speed Display Mode Switching

The PTO speed display mode has been factory-set as table below. Do not attempt to change the code. Otherwise the correct PTO speed will not be displayed in the LCD monitor.

(NOTE: The current code can be checked in the following procedure.)

#### ◆ Switching procedure

- ① While pressing the PTO/Hour meter select switch, turn the key switch to "ON" position.

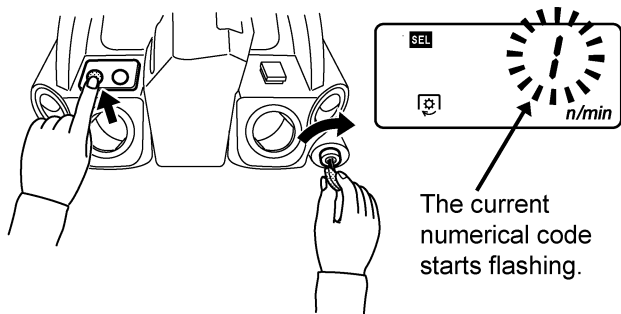

- ② Each time the PTO/Hour meter select switch is pressed, the code changes in the order of [1]→[2]→[1], [1]→[2]→[3]→[4]→[5]→[1]. Select the appropriate code according to the table below.

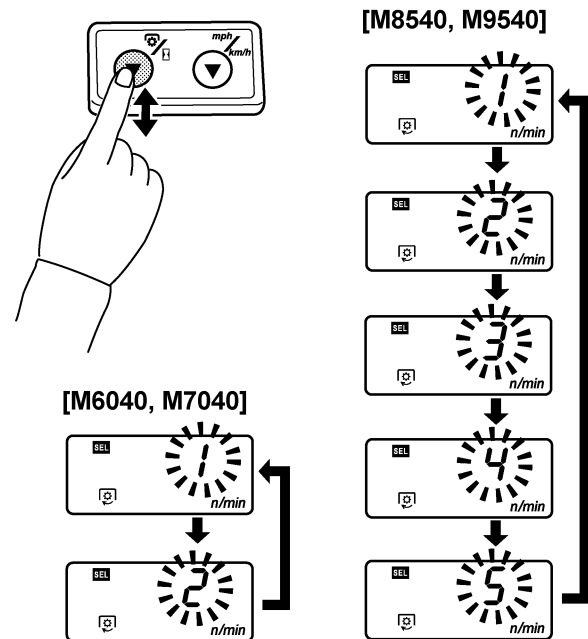

1AGAIDVAP009A

- ③ Press and hold the PTO/Hour meter select switch longer than 2 seconds. The setting is put in memory, and the LCD monitor goes back to the PTO speed display mode.

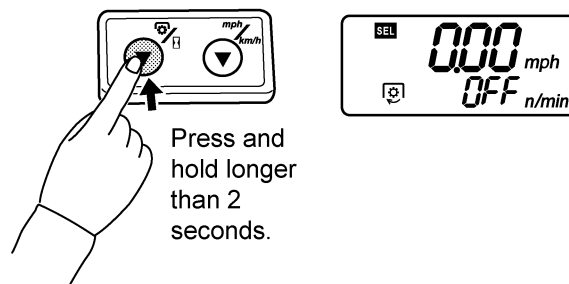

#### NOTE:

- The setting will be cancelled if the key switch is turned OFF halfway in the procedure.

Model	Numerical code	PTO speed (rpm)
M6040 M7040	1	540 / 540E (Oceania models)
M8540 M9540	4	

- It is the ban selection except the above mentioned code number.



## OPERATING TECHNIQUES

### Trailer Electrical Outlet

A trailer electrical outlet is supplied for use with trailer or implement.

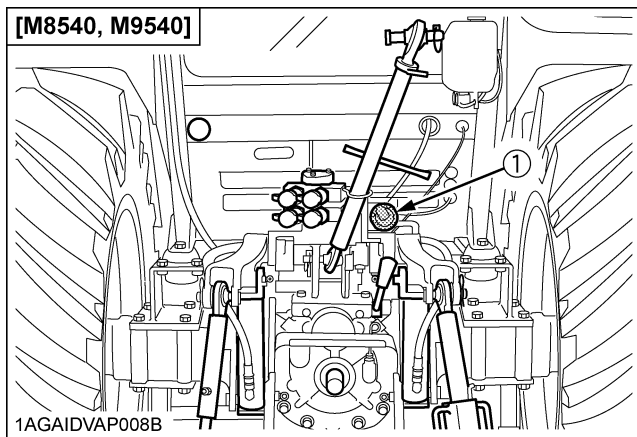
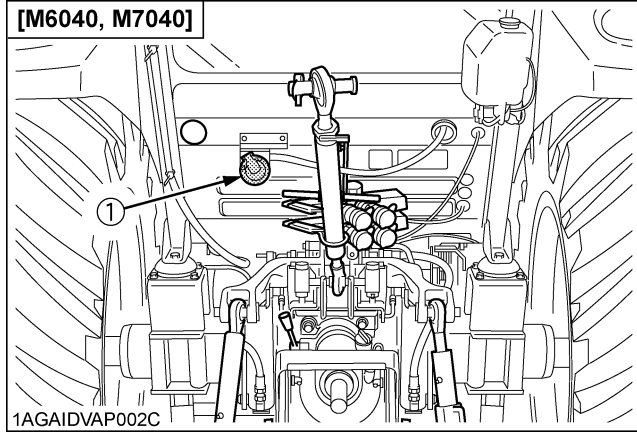

(1) Trailer electrical outlet

### Function of each terminals in trailer electrical outlet

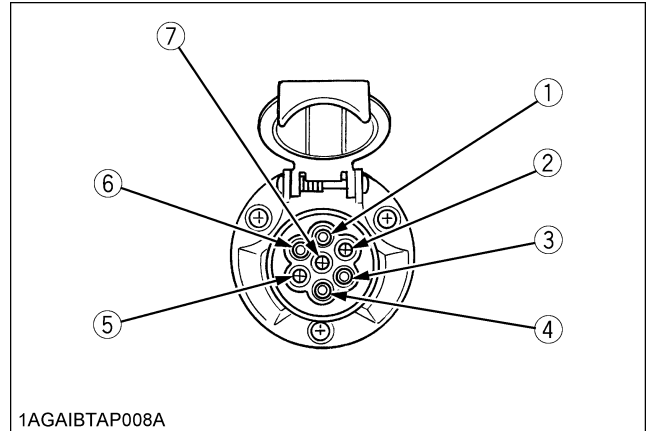

Terminal	Function
(1)	Turn signal light (LH)
(2)	---
(3)	Ground
(4)	Turn signal light (RH)
(5)	Tail light Sidemarket light Parking light
(6)	Brake stop light
(7)	Registration plate light

# PTO

## PTO OPERATION



### CAUTION

To avoid personal injury:

- Disengage PTO, stop engine, and allow all rotating components to come to a complete stop before connecting, disconnecting, adjusting, or cleaning any PTO driven equipment.

### PTO Gear Shift Lever



### WARNING

To avoid personal injury:

- Be sure to observe the PTO shaft speed prescribed for the individual implements. It is extremely dangerous to run an implement at high speed that is meant to be operated at low speed. Use only when this higher rpm is specifically recommended by the implement manufacturer.

The PTO gear shift lever can be set to either 540 rpm or 540E rpm positions.

Move this lever to either position with the PTO clutch control switch or lever set to "OFF".

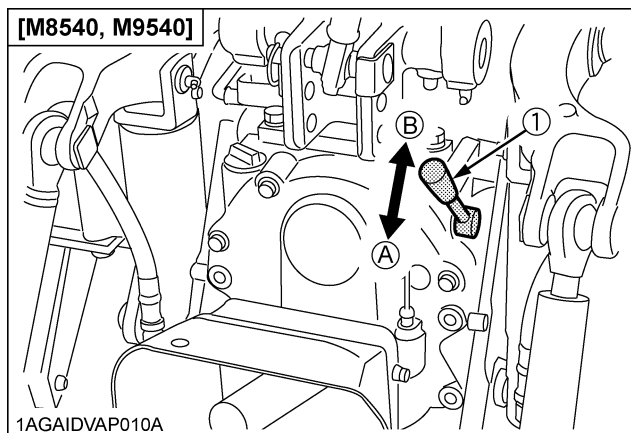
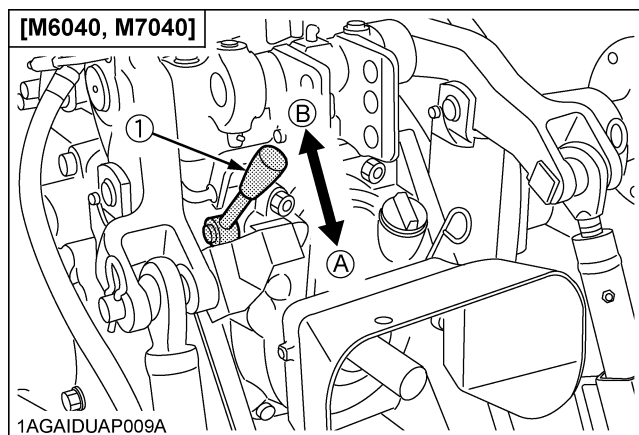

(1) PTO gear shift lever

(A) 540 rpm

(B) 540E rpm

#### NOTE :

- When light load, select the "540E" position for economical operation.

### PTO Clutch Control Lever

[Without Dual Speed model]

The PTO clutch control lever engages or disengages the PTO clutch which gives the PTO independent control. Shift the lever to "ON" to engage the PTO clutch. Shift the lever to "OFF" to disengage the PTO clutch.

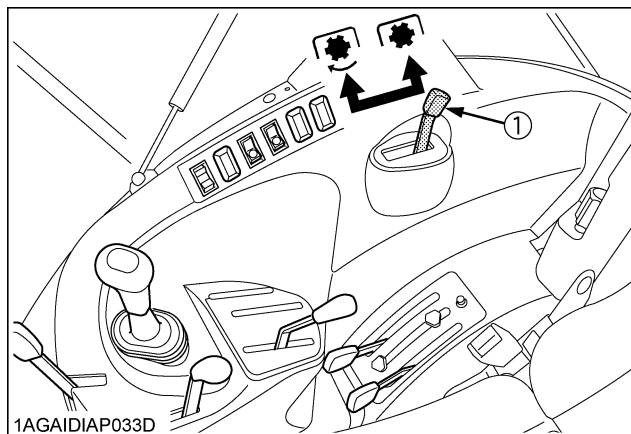

(1) PTO clutch control lever

☛ "ON" (Engaged)

☛ "OFF" (Disengaged)

#### IMPORTANT :

- To avoid shock loads to the PTO, reduce engine speed when engaging the PTO, then open the throttle to the recommended speed.
- To avoid damage of PTO clutch and implement, shift the PTO clutch control lever slowly, when engaging the PTO clutch. Do not keep the PTO clutch control lever half way.

Tractor model	(A) 540	(B) 540E
	PTO / Engine speed rpm	
M6040 M7040	540 / 2160	540 / 1825
M8540 M9540	540 / 2035	540 / 1519

**NOTE :**

- Tractor engine will not start if PTO clutch control lever is in the engaged "ON" position.
- If the PTO system is engaged and you stand up from the seat, the warning buzzer will whistle for about 10 seconds after standing up. This is because the tractor is equipped with "Operator Presence Control System".

**◆ PTO Clutch Indicator**

The PTO clutch indicator turns on while PTO clutch control lever is in "ON" (Engage) position.

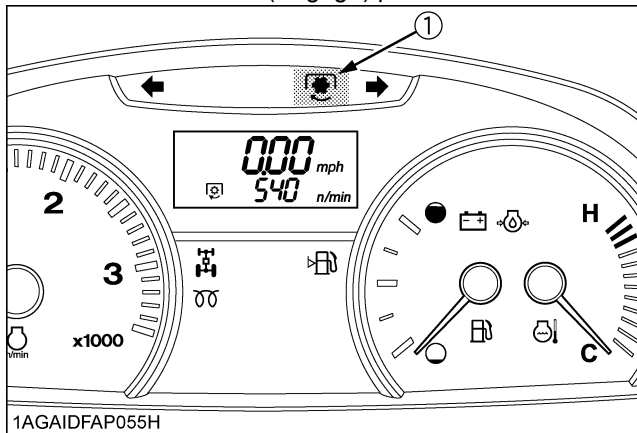

(1) PTO clutch indicator

**■ PTO Clutch Control Switch**

[With Dual Speed model]

The PTO clutch control switch engages or disengages the PTO clutch which gives the PTO independent control. Turn the switch to "ON" to engage the PTO clutch. Turn the switch to "OFF" to disengage the PTO clutch.

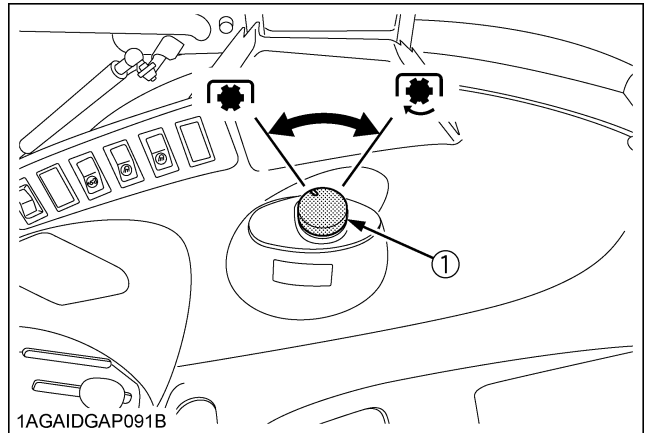

(1) PTO clutch control switch    ⚙️ "ON"    ⚙️/ "OFF"

**◆ PTO Clutch Control Switch**

**To turn ON**

While pushing the switch, turn clockwise to the "ON" position and release your hand. (In the ON position, switch slightly rises itself.)

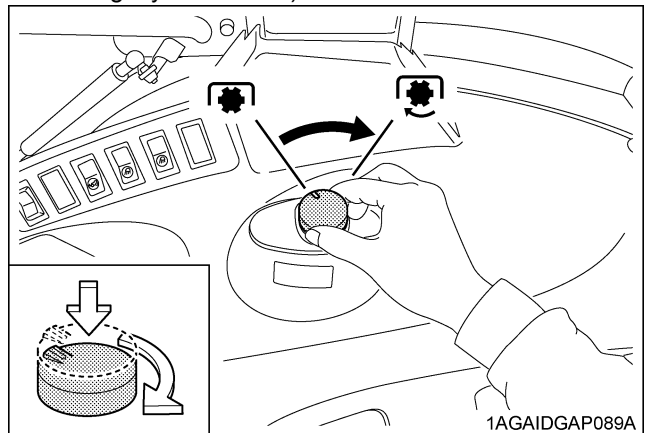

1AGAIDGAP089A

**To Turn OFF**

Tap on top of the switch, and the switch will return to the OFF position.

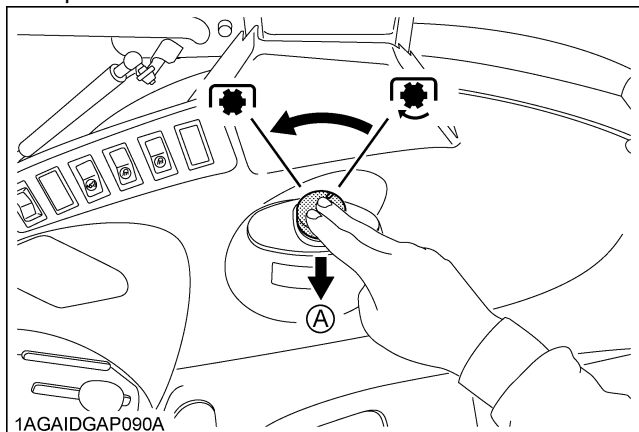

(A) "PUSH"

**IMPORTANT :**

- To avoid shock loads to the PTO, reduce engine speed when engaging the PTO, then open the throttle to the recommended speed.

**NOTE :**

- Tractor engine will not start if PTO clutch control switch is in the engaged "ON" position.
- If the PTO system is engaged and you stand up from the seat, the warning buzzer will whistle for about 10 seconds after standing up. This is because the tractor is equipped with "Operator Presence Control System".

**◆ PTO Clutch Indicator**

The PTO clutch indicator turns on while PTO clutch control switch is in "ON" (Engage) position.

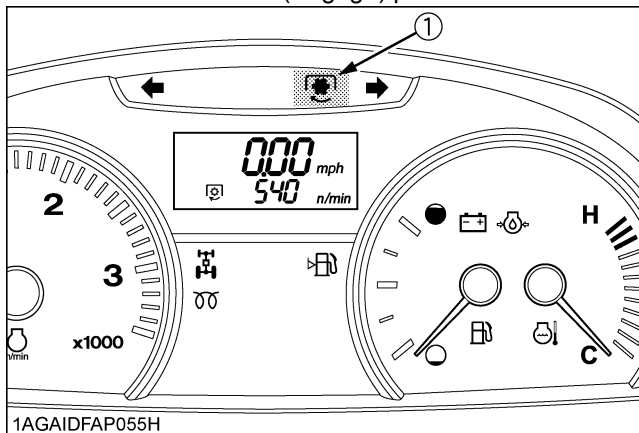

(1) PTO clutch indicator

**■ LCD Monitor Message**

1. The PTO rpm can be checked in the LCD monitor. (See "PTO RPM / TRAVEL SPEED MONITOR" in "OPERATING THE TRACTOR" section.)
2. When the PTO system gets engaged (ON), the indicator lights up.

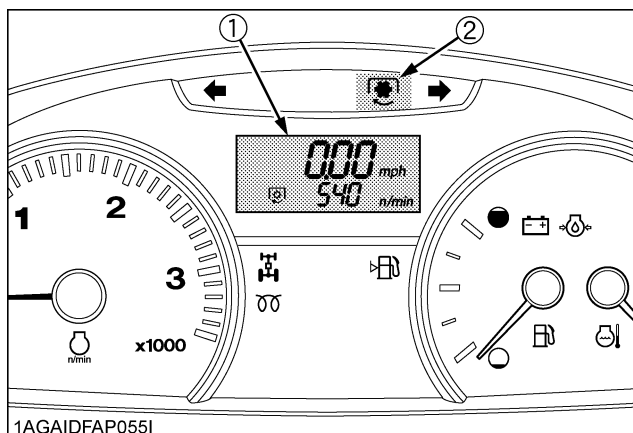

(1) LCD monitor  
(2) PTO clutch indicator

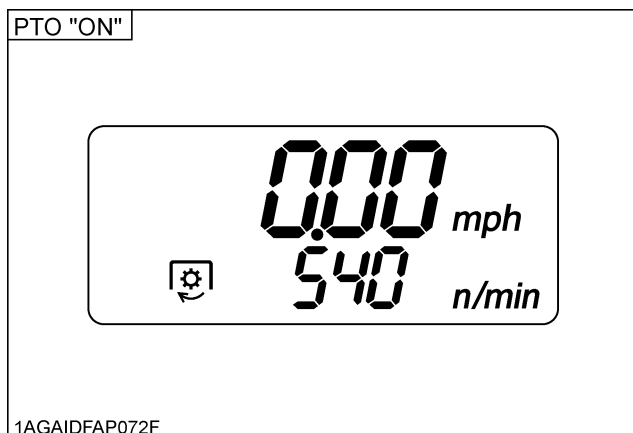

# 3-POINT HITCH & DRAWBAR

## 3-POINT HITCH

### ■ Remote Hitch UP / DOWN Lever

[With Dual Speed model]

#### CAUTION

To avoid personal injury:

- Do not use the Remote hitch up / down lever when the implement is attached on the 3-point hitch.

This lever is used to raise and lower the 3-point hitch for aligning the arm with the implement only.

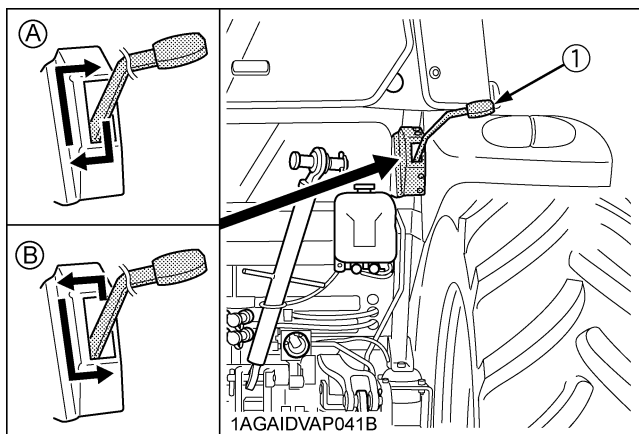

(1) Remote hitch up / down lever

(A) "UP"

(B) "DOWN"

## DRAWBAR

#### WARNING

To avoid personal injury:

- Never pull from the top link, the rear axle or any point above the drawbar. Doing so could cause the tractor to tip over rearward causing personal injury or death.

### ■ Adjusting Drawbar Length

When towing an implement, it is recommended that the (A) hole in drawbar be utilized.

The drawbar load is specified in the "IMPLEMENT LIMITATIONS" section.

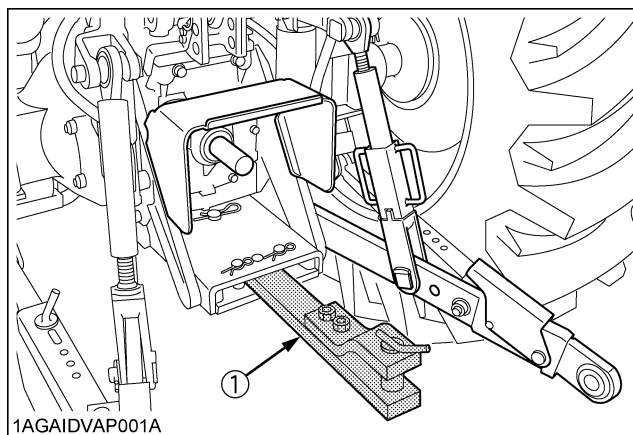

1AG AIDVAP001A

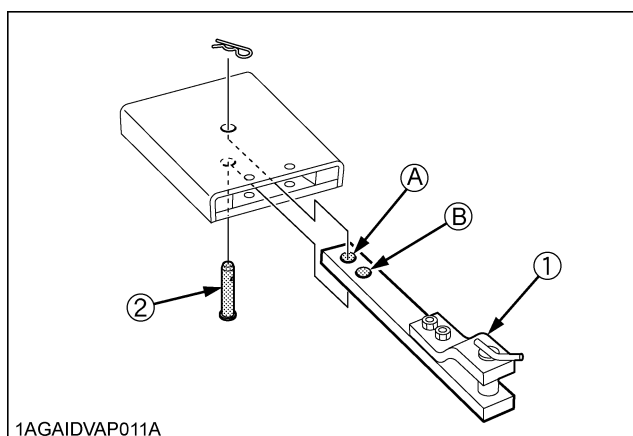

1AG AIDVAP011A

(1) Drawbar

(2) Pivot pin

Holes: (A), (B)



## ■ Swing Drawbar

The drawbar can be used in 3 different ways as illustrated below. Assemble it correctly with locating pins.

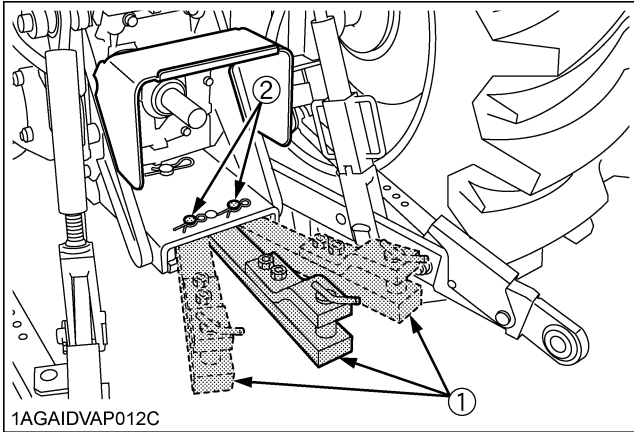

- (1) Drawbar
- (2) Locating pin

# HYDRAULIC UNIT

## REMOTE HYDRAULIC CONTROL SYSTEM

The hydraulic auxiliary control valves can be installed up to triple segments.

It is not possible to use triple segments with flow control valve.

### Remote Control Valve

There are 3 types of remote valves available for these models.

- **Double acting valve with detents and self cancelling:**  
This valve may be placed in the detent mode. The lever will stay in this position until the pressure reaches a predetermined level or a cylinder reaches the end of its stroke. Then it will automatically return to neutral.
- **Double acting valve with float position:**  
This valve may be placed in the float mode with the control lever all the way forward. The cylinder is free to extend or retract, letting an implement such as a loader bucket follow the ground.
- **Single/double acting valve:**  
This valve can be utilized as single or double acting valve by adjusting the auxiliary control valve selector knob located on the valve.
  - 1) Turn the auxiliary control valve selector knob clockwise all the way to utilize as single acting valve.
  - 2) Turn the auxiliary control valve selector knob anticlockwise all the way to utilize as double acting valve.

**NOTE :**

- This float valve can be attached as the second or third segment.

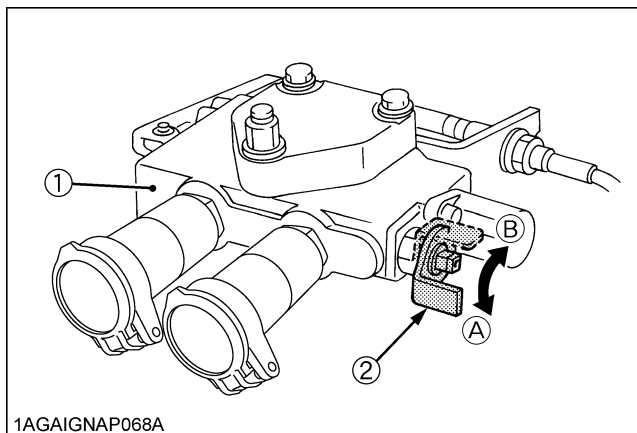

(1) Single / double acting valve  
(2) Auxiliary control valve selector knob

(A) Double acting  
(B) Single acting

### Remote Control Valve Lever

The remote control valve lever directs pressurized oil flow to the implement hydraulic system.

[Without Dual Speed model]

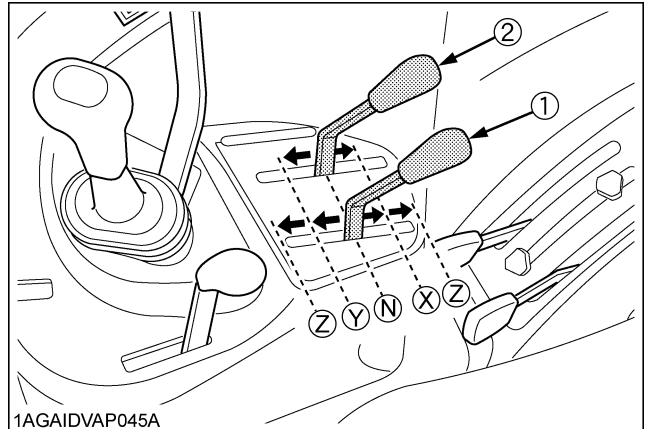

(1) Remote control valve lever with Double acting valve /  
(2) Detents and self cancelling  
Remote control valve lever with Single / Double acting valve

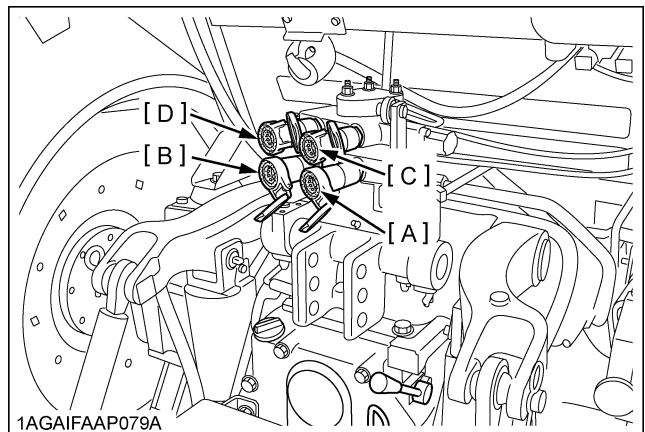

1AGAIFAAP079A

Pressure →  
Returning ←

Lever (1)		Lever position			
		Z (detent)	Y	X	Z (detent)
Port	[A]	Out →		In ←	
	[B]	In ←		Out →	

		Double-acting		Single-acting	
Lever (2)		Y	X	Y	X
Port	[C]	Out →	In ←	-	-
	[D]	In ←	Out →	In ←	Out →

**[With Dual Speed model]**

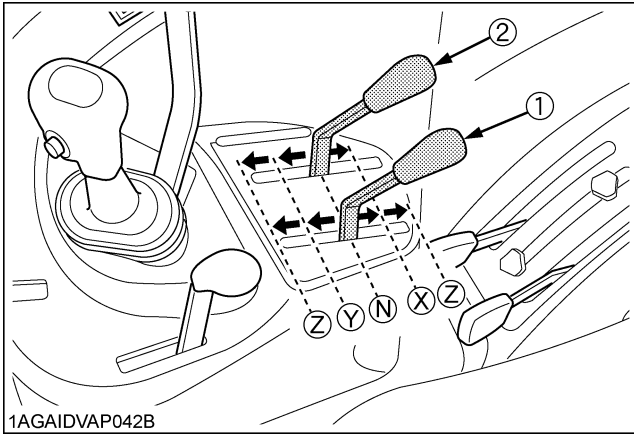

(1) Remote control valve lever with Double acting valve /  
 (2) Detents and self cancelling  
 Remote control valve lever with Double acting valve /  
 Float position

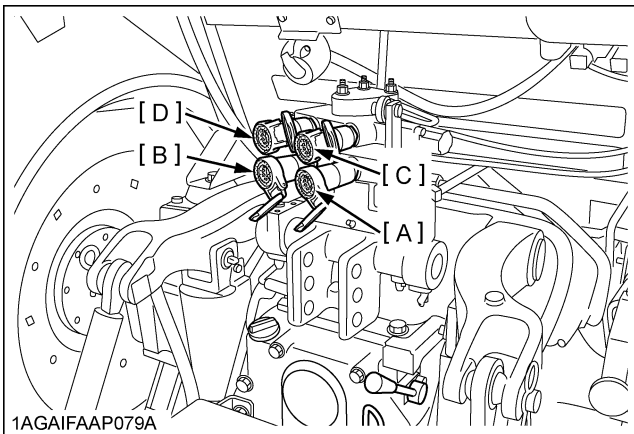

Pressure →  
 Returning ←

Lever (1)		Lever position			
		Z (detent)	Y	X	Z (detent)
Port	[A]	Out →		In ←	
	[B]	In ←		Out →	

Lever (2)		Lever position		
		Z (detent)	Y	X
Port	[C]	In	Out →	In ←
	[D]	Out	In ←	Out →

**IMPORTANT :**

- Do not hold the lever in the "REARWARD" or "FORWARD" position once the remote cylinder has reached the end of the stroke, as this will cause oil to flow through the relief valve. Forcing oil through the relief valve for extended periods will overheat the oil.
- When using the tractor hydraulic system to power front loader, do not operate boom and bucket cylinders simultaneously.

**NOTE :**

- Connect the pressure of load side of implement cylinders to ports [B] or [D] which have built in load check valve to prevent leak down.
- To use the single-acting cylinder with the float valve, connect this cylinder to the [B] or [D] port. To extend a single-acting cylinder, pull the remote control valve lever rearward. To retract a cylinder, push it fully forward to the "FLOAT" position. Do not hold it in the "FORWARD" position, the transmission fluid may be overheat.

# TIRES, WHEELS AND BALLAST

## TIRES



### WARNING

To avoid personal injury:

- Do not attempt to mount a tire on a rim. This should be done by a qualified person with the proper equipment.
- Always maintain the correct tire pressure. Do not inflate tires above the recommended pressure shown in the operator's manual.

### IMPORTANT :

- Do not use tires other than those approved by KUBOTA.

### NOTE :

- When optional different-diameter tires are fitted on the machine, the travel speed display mode must be changed. Otherwise the travel speed will not get correctly displayed. Such mode switching is also needed when the original tires are back on the machine.  
(See "PTO RPM / TRAVEL SPEED MONITOR" in "OPERATING THE TRACTOR" section.)

### ■ Inflation Pressure

Though the tire pressure is factory-set to the prescribed level, it naturally drops slowly in the course of time. Thus, check it everyday and inflate as necessary.

	Tire sizes	Inflation Pressure
Front	6.50-16, 6PR	320 kPa (3.2 kgf/cm <sup>2</sup> )
	7.50-16, 6PR	280 kPa (2.8 kgf/cm <sup>2</sup> )
	9.5L-15, 6PR	220 kPa (2.2 kgf/cm <sup>2</sup> )
	9.5-20, 6PR	200 kPa (2.0 kgf/cm <sup>2</sup> )
	9.5-22, 6PR	200 kPa (2.0 kgf/cm <sup>2</sup> )
	9.5-24, 6PR	180 kPa (1.8 kgf/cm <sup>2</sup> )
	360/70R24	160 kPa (1.6 kgf/cm <sup>2</sup> )
Rear	14.9-28, 6PR	140 kPa (1.4 kgf/cm <sup>2</sup> )
	16.9-28, 6PR	120 kPa (1.2 kgf/cm <sup>2</sup> )
	16.9-30, 6PR	120 kPa (1.2 kgf/cm <sup>2</sup> )
	18.4-30, 6PR	120 kPa (1.2 kgf/cm <sup>2</sup> )
	16.9-34, 6PR	120 kPa (1.2 kgf/cm <sup>2</sup> )
	480/70R34	120 kPa (1.2 kgf/cm <sup>2</sup> )

### NOTE :

- Maintain the maximum pressure in front tires, if using a front loader or when equipped with a full load of front weights.

### ■ Dual Tires

Dual tires are not approved.

## WHEEL ADJUSTMENT



### CAUTION

To avoid personal injury:

- When working on slopes or when working with trailer, set the wheel tread as wide as practical for maximum stability.
- Support tractor securely on stands before removing a wheel.
- Do not work under any hydraulically supported devices. They can settle, suddenly leak down, or be accidentally lowered. If necessary to work under tractor or any machine elements for servicing or adjustment, securely support them with stands or suitable blocking beforehand.
- Never operate tractor with a loose rim, wheel, or axle.

**■ Front Wheels (with 4 wheel drive)**

Front tread width can be adjusted as shown with the standard equipped tires.

To change the tread width

1. Remove the wheel rim and disk mounting bolts.
2. Change the position of the rim and disk (right and left) to the desired position, and tighten the bolts.
3. Adjust the toe-in: [ 2 to 8mm ]  
See "Adjusting Toe-in" in "EVERY 200 HOURS" in "PERIODIC SERVICE" section.

**IMPORTANT :**

- Always attach wheels as shown in the drawing.
- If not attached as illustrated, transmission parts may be damaged.
- When re-fitting or adjusting a wheel, tighten the bolts to the following torques then recheck after driving the tractor 200m (200 yards) and thereafter according to service interval. (See "MAINTENANCE" section.)

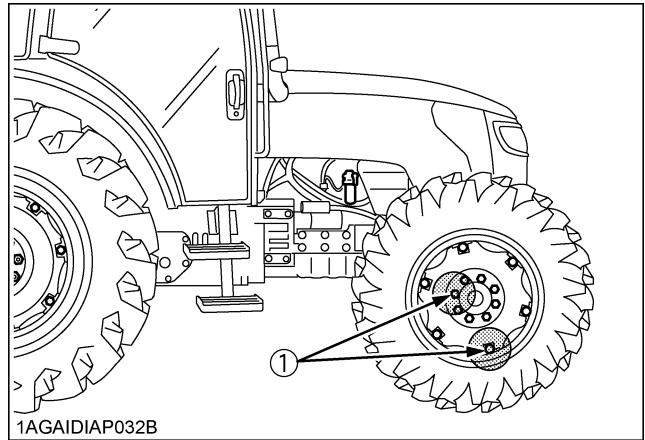

(1) 260 to 304 N-m (26.5 to 31 kgf-m)

**NOTE :**

- Wheels with beveled or tapered holes: Use the tapered side of lug nut.

<p>1AGAI SAP0711</p>		<p>1AGAI SAP072A</p>		<p>1AGAI SAP073A</p>	
M6040	9.5-24	1420 mm	1440mm	1520 mm	
M7040	9.5-22	1510 mm	---	---	
M8540	12.4-24	1560 mm	1540mm	1660 mm	
M9540	360/70R24	1560 mm	1540mm	1660 mm	

**■ Rear Wheels**

Rear tread width can be adjusted as shown with the standard equipped tires.

To change the tread width

1. Remove the wheel rim and / or disk mounting bolts.
2. Change the position of the rim and / or disk (right and left) to the desired position, and tighten the bolts.

**IMPORTANT :**

- Always attach wheels as shown in the drawing.
- If not attached as illustrated, transmission parts may be damaged.
- When re-fitting or adjusting a wheel, tighten the bolts to the following torques then recheck after driving the tractor 200m (200 yards) and thereafter according to service interval.  
(See "MAINTENANCE" section.)

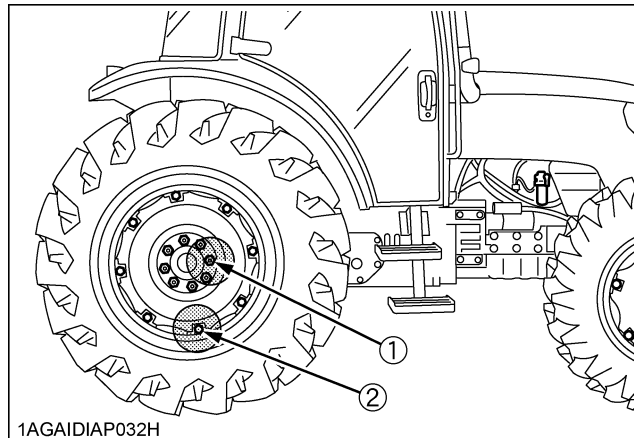

N-m (kgf-m)

	(1)	(2)
M6040, M7040	260 to 304 (26.5 to 31.0)	260 to 304 (26.5 to 31.0)
M8540, M9540	343 to 402 (35.0 to 41.0)	

Rear wheel disc		Rear wheel rim		Tread		Tread		Tread		Tread	
1AGAIDVAP043A											
M6040	16.9-28 (steel disc)	---	1420 mm	1520 mm	1620 mm	1720 mm					
M7040	16.9-30 (steel disc)										
M8540 M9540	18.4-30 (steel disc)	1540 mm	1620 mm	1740 mm	1820 mm	1940 mm					
	16.9-34 (cast iron disc)	1500 mm	1650 mm	1780 mm	1850 mm	1980 mm					
	480/70R34	1498 mm	1598 mm	1698 mm	1798 mm	1898 mm					

# MAINTENANCE

## SERVICE INTERVALS

No.	Items		Indication on hour meter													Interval	Ref. page			
			50	100	150	200	250	300	350	400	450	500	550	600	650				700	
<b>[M6040, M7040]</b>																				
1	Fan / Air-conditioner belt	Adjust		○		○		○		○		○		○		○	every 100 Hr	*		
2	Alternator belt	Adjust		○		○		○		○		○		○		○	every 100 Hr	*		
<b>[M8540, M9540]</b>																				
1	Fan belt	Adjust		○		○		○		○		○		○		○	every 100 Hr	*		
2	Parking brake lever	Adjust		○		○		○		○		○		○		○	every 100 Hr	28		
	Gear locked parking lever	Check		○		○		○		○		○		○		○	every 100 Hr	28		
3	Turbo charger	Check															every 3000 Hr	*	*4	
4	Intake air heater	Check															every 3000 Hr	*	*4	
5	Master cylinder filter	Clean															every 2 years	*	*4	
6	Master cylinder kit	Replace															every 2 years	*	*4	
7	Equalizer kit	Replace															every 2 years	*	*4	
8	Brake seal 1 and 2	Replace															every 2 years	*	*4	
9	Brake system	Bleed															Service as required	*	*4	
<b>[COMMON ITEMS]</b>																				
1	Engine start system	Check	○	○	○	○	○	○	○	○	○	○	○	○	○	○	○	every 50 Hr	*	
2	Wheel bolt torque	Check	○	○	○	○	○	○	○	○	○	○	○	○	○	○	○	every 50 Hr	*	
3	Battery condition	Check		○		○		○		○		○		○		○	every 100 Hr	*	*5	
4	Greasing	---		○		○		○		○		○		○		○	every 100 Hr	*		
5	Brake pedal	Adjust		○		○		○		○		○		○		○	every 100 Hr	*		
6	Clutch pedal [Synchro shuttle model]	Adjust	◎	○		○		○		○		○		○		○	every 100 Hr	*		

No.	Items		Indication on hour meter													Interval	Ref. page				
			50	100	150	200	250	300	350	400	450	500	550	600	650				700		
7	Air cleaner element	Primary element	Clean		○		○		○		○		○		○		○	every 100 Hr	*	*1	
			Replace																every 1 year	*	*2
		Secondary element	Replace																every 1 year	*	
8	Fuel line	Check		○		○		○		○		○		○		○		○	every 100 Hr	*	
		Replace																	every 2 years	*	*4
9	Toe-in	Adjust				○				○				○				every 200 Hr	*		
10	Fuel tank water	Drain				○				○				○				every 200 Hr	*		
11	Intake air line	Check				○				○				○				every 200 Hr	*		
		Replace																every 2 years	*	*3	
12	Power steering oil line	Check				○				○				○				every 200 Hr	*		
		Replace																every 2 years	*	*4	
13	Radiator hose and clamp	Check				○				○				○				every 200 Hr	*		
		Replace																every 2 years	*		
14	Engine oil	Change	◎						○					○				every 300 Hr	*		
15	Hydraulic oil filter	Replace	◎						○					○				every 300 Hr	*		
16	Greasing (2WD front wheel hub)	---								○								every 400 Hr	*		
17	Water separator	Clean								○								every 400 Hr	*		
18	Fuel filter	Replace								○								every 400 Hr	*		
19	Engine oil filter	Replace	◎											○				every 600 Hr	*		
20	Transmission fluid	Change	◎											○				every 600 Hr	*		
21	Front differential case oil	Change	◎											○				every 600 Hr	*		
22	Front axle gear case oil	Change	◎											○				every 600 Hr	*		
23	Front axle pivot	Adjust												○				every 600 Hr	*		
24	Engine valve clearance	Adjust																every 800 Hr	*	*4	
25	Fuel injection nozzle injection pressure	Check																every 1500 Hr	*	*4	



No.	Items		Indication on hour meter													Interval	Ref. page			
			50	100	150	200	250	300	350	400	450	500	550	600	650				700	
26	Injection pump	Check																every 3000 Hr	*	*4
27	Cooling system	Flush																every 2 years	*	
28	Coolant	Change																every 2 years	*	
29	Lift cylinder hose	Replace																every 2 years	*	*4
30	Fuel system	Bleed																Service as required	*	
31	Clutch housing water	Drain																Service as required	*	
32	Fuse	Replace																Service as required	28	
33	Light bulb	Replace																Service as required	30	

\* : See operator's manual issued separately for the sister model. [M6040, M7040, M8540, M9540]

**IMPORTANT :**

- The jobs indicated by © must be done after the first 50 hours of operation.
- \*1 Air cleaner should be cleaned more often in dusty conditions than in normal conditions.
- \*2 Every year or every 6 times of cleaning.
- \*3 Replace only if necessary.
- \*4 Consult your local KUBOTA Dealer for this service.
- \*5 When the battery is used for less than 100 hours per year, check the battery condition by reading the indicator annually.

# PERIODIC SERVICE

## EVERY 100 HOURS

### ■ Adjusting Parking Brake Lever



#### CAUTION

To avoid personal injury:

- Stop the engine and chock the wheels before checking parking brake.

Proper parking brake lever free travel	3 to 5 notches (Ratchet sound 3 to 5)
--	--

1. Raise the parking brake lever to the parking position while counting the ratchet sound made by the parking brake lever.
2. If adjustment is needed, loosen the lock nut and adjust the parking brake rod length with in acceptable limit.
3. Retighten the lock nut.

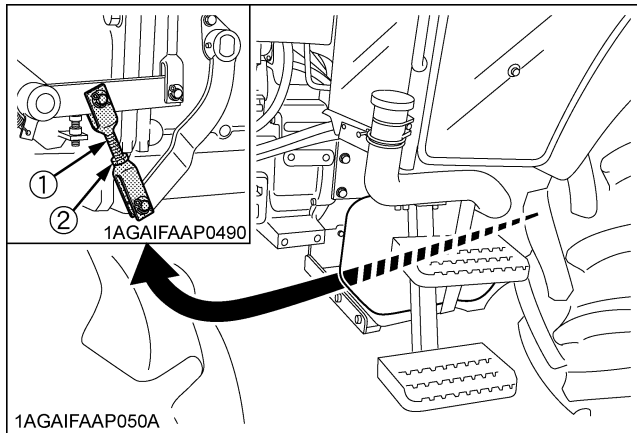

(1) Parking brake rod  
(2) Lock nut

### ■ Checking Gear Locked Parking Lever



#### CAUTION

To avoid personal injury:

- Do not dismounting the tractor while checking the gear locked parking lever.

Confirm the tractor (tractor unit only) can surely be parked on the slope of about 15 degrees (Slope that rises by 2.7 meters every 10 meters).

If the tractor moves, consult your local KUBOTA Dealer. Always engage the gear locked parking lever before dismounting the tractor.

## SERVICE AS REQUIRED

### ■ Replacing Fuse

The tractor electrical system is protected from potential damage by fuses.

A blown fuse indicates that there is an overload or short somewhere in the electrical system.

If any of the fuses should blow, replace with a new one of the same capacity.

#### IMPORTANT :

- Before replacing a blown fuse, determine why the fuse blew and make any necessary repairs. Failure to follow this procedure may result in serious damage to the tractor electrical system. Refer to the "TROUBLESHOOTING" section of this manual or your local KUBOTA Dealer for specific information dealing with electrical problems.

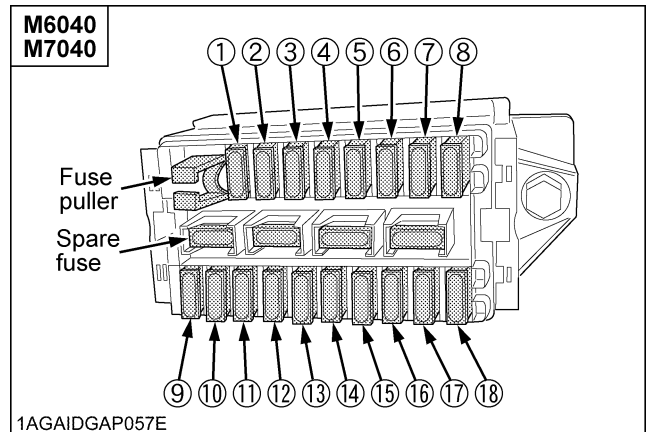
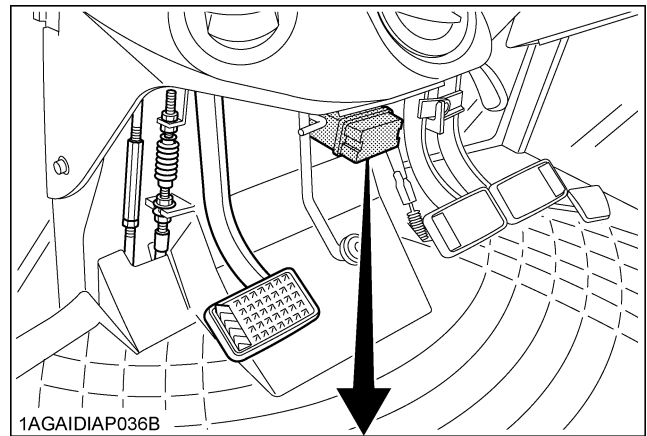

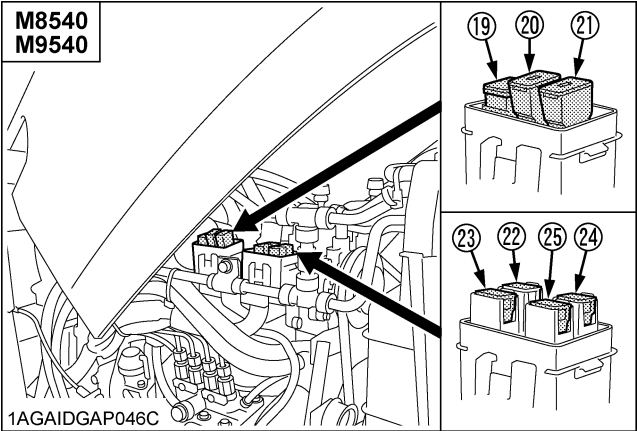
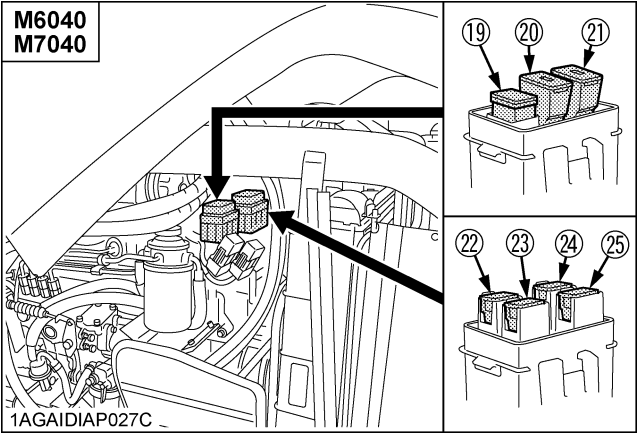
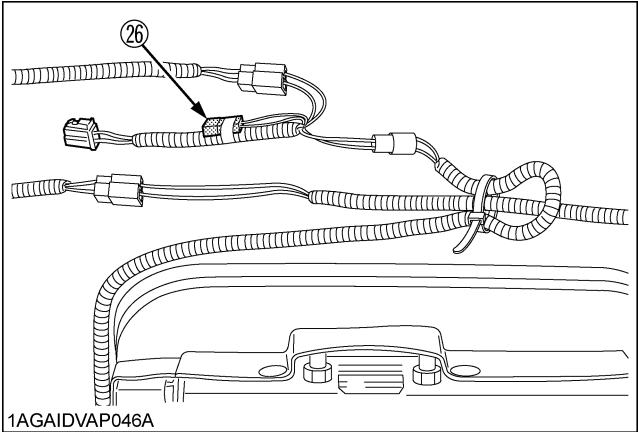
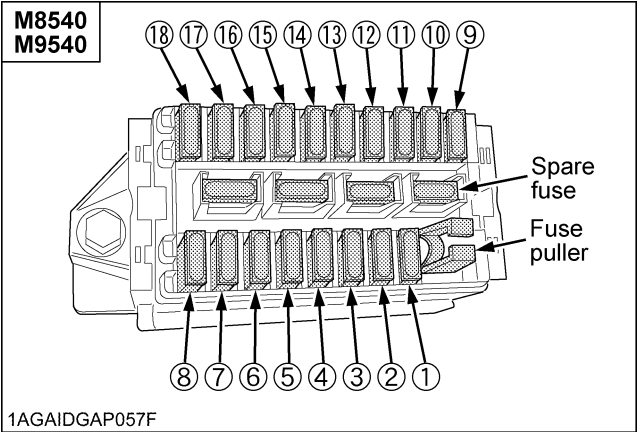

Fuse No.	Capacity (A)	Protected circuit
(1)	5	Starter Relay
(2)	15	Auxiliary Power / Air Suspension Seat (if equipped)
(3)	15	Work Light (Front, Side)
(4)	10	Air Conditioner (Compressor)
(5)	30	Air Conditioner (Fan Motor)
(6)	15	Cigarette Lighter
(7)	15	Work Light (Front)
(8)	15	Work Light (Rear)
(9)	20	Spare Fuse
(10)	20	Flasher (Hazard)
(11)	20	Head Light, Tail Lamp
(12)	10	Meter, Radio (Back Up), Horn
(13)	10	Turn Signal, Stop Lamp
(14)	5	Meter Panel, OPC
(15)	5	Alternator, Engine, Heater
(16)	15	Wiper
(17)	5	Air Conditioner (Control)
(18)	5	Radio
(19)	100	Charge
(20)	50	Air Heater
(21)	50	Head Light, Hazard
(22)	30	Work Light, Fuel Cut Solenoid
(23)	30	Key Switch
(24)	30	Electrical Outlet
(25)	40	Air Conditioner
(26)	15	Air Suspension Seat (if equipped)

**■ Replacing Light Bulb**

Light	Capacity
Head lights	12 V, 55 / 60 W (H4)
Turn signal / Hazard lights	12 V, 21 W
Brake stop light / Tail light	12 V, 21 / 5 W
Work light (for outer roof)	12 V, 55 W
Front work light	12 V, 21 W
Dome light (Room lamp)	12 V, 5 W

# OPTIONS

Consult your local KUBOTA Dealer for further details.

- Double Acting Remote Hydraulic Control Valve with Detents and Self-Cancelling
- Flow Control Valve Kit
- Double Acting Remote Hydraulic Control Valve with Detents and Self-Cancelling for Flow Control Valve
- Double Acting Remote Hydraulic Control Valve with Float Position
- Front end weights  
For front ballast
- Rear Wheel Weights  
For rear ballast